

# 3701 MIRAMAR

## WINE CELLAR

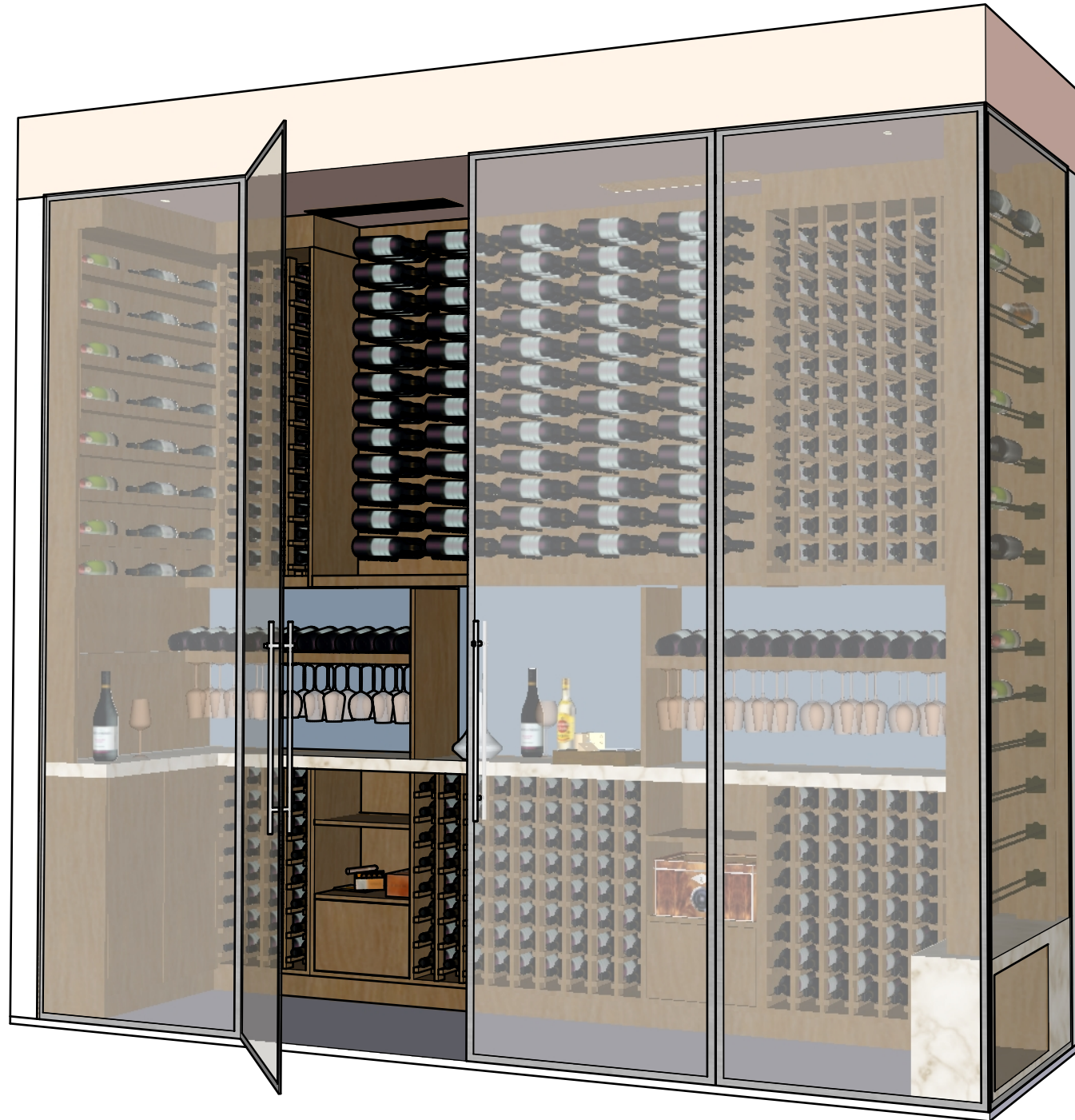

### PROGRESS DRAWING

This presentation is not intended to be used for contract pricing or fabrication purposes. All content is subject to change.

DISCARD ALL PRESENTATIONS THAT WERE MADE ON THIS ITEM PRIOR TO THE DATE BELOW:

**02/8/2022**

#### NOTES

The drawings included in presentations may not be scaled. The numerical dimensions represent correct measurements. All dimensions are given from finished floor and finished wall unless otherwise noted. All design ideas, drawings and plans represented here are owned by the property of **WESTHAVEN CONSTRUCTION SERVICES**. Above suggested electrical and plumbing locations, must be verified in field.

### PROJECT

**3701  
MIRAMAR**

### PAGE NAME

Cover Page

### DESIGN BY

J. ALONSO

### DRAWING BY

A. QUINTERO

### CREATED

12/ 21/ 2021

### MODIFIED

02/8/2022

### CLIENT

J&Y

### ADDRESS

0000  
Fl, 33000



8254 NW SOUTH RIVER DRIVE, MEDLEY, FL 33166  
All rights reserved.

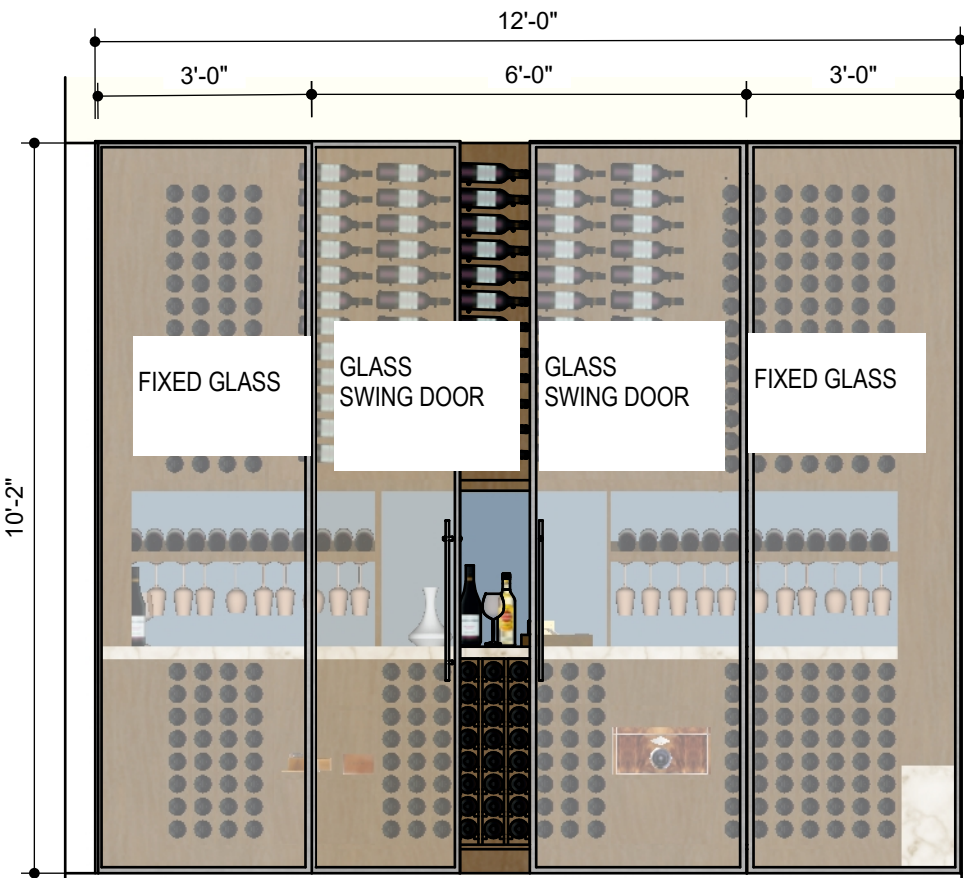
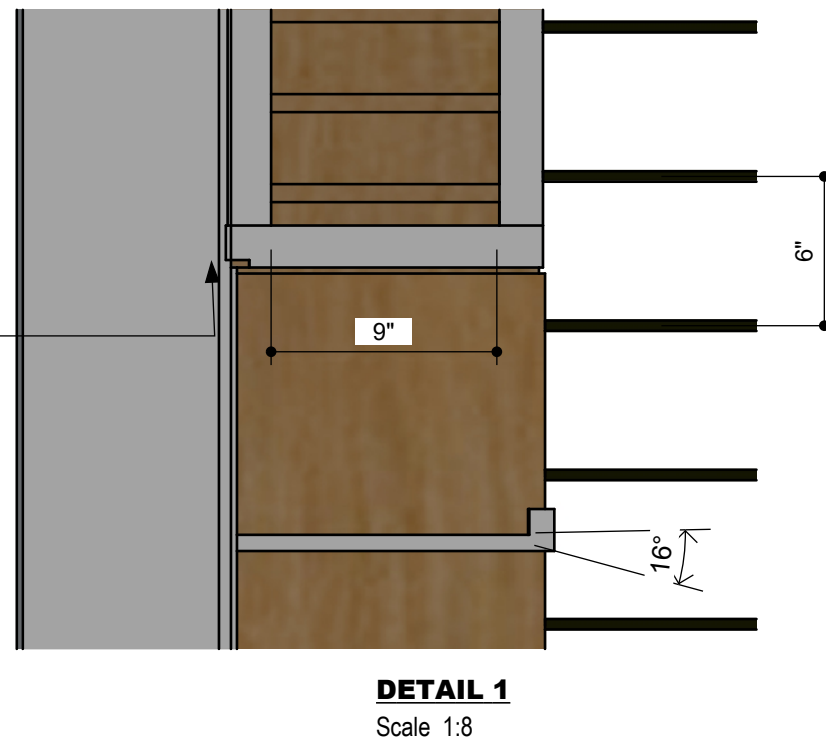
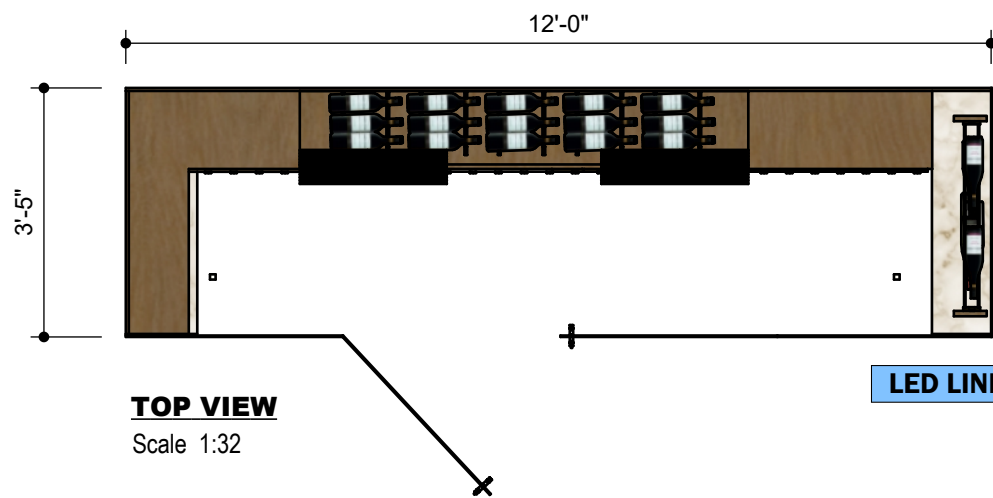
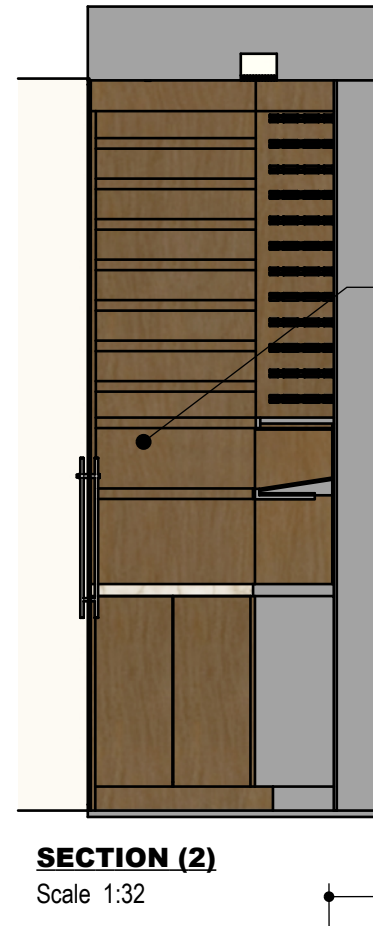
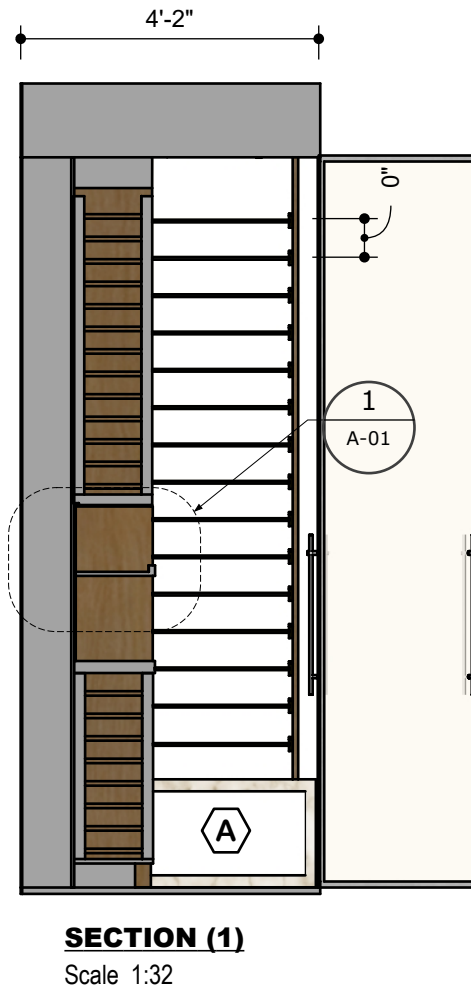
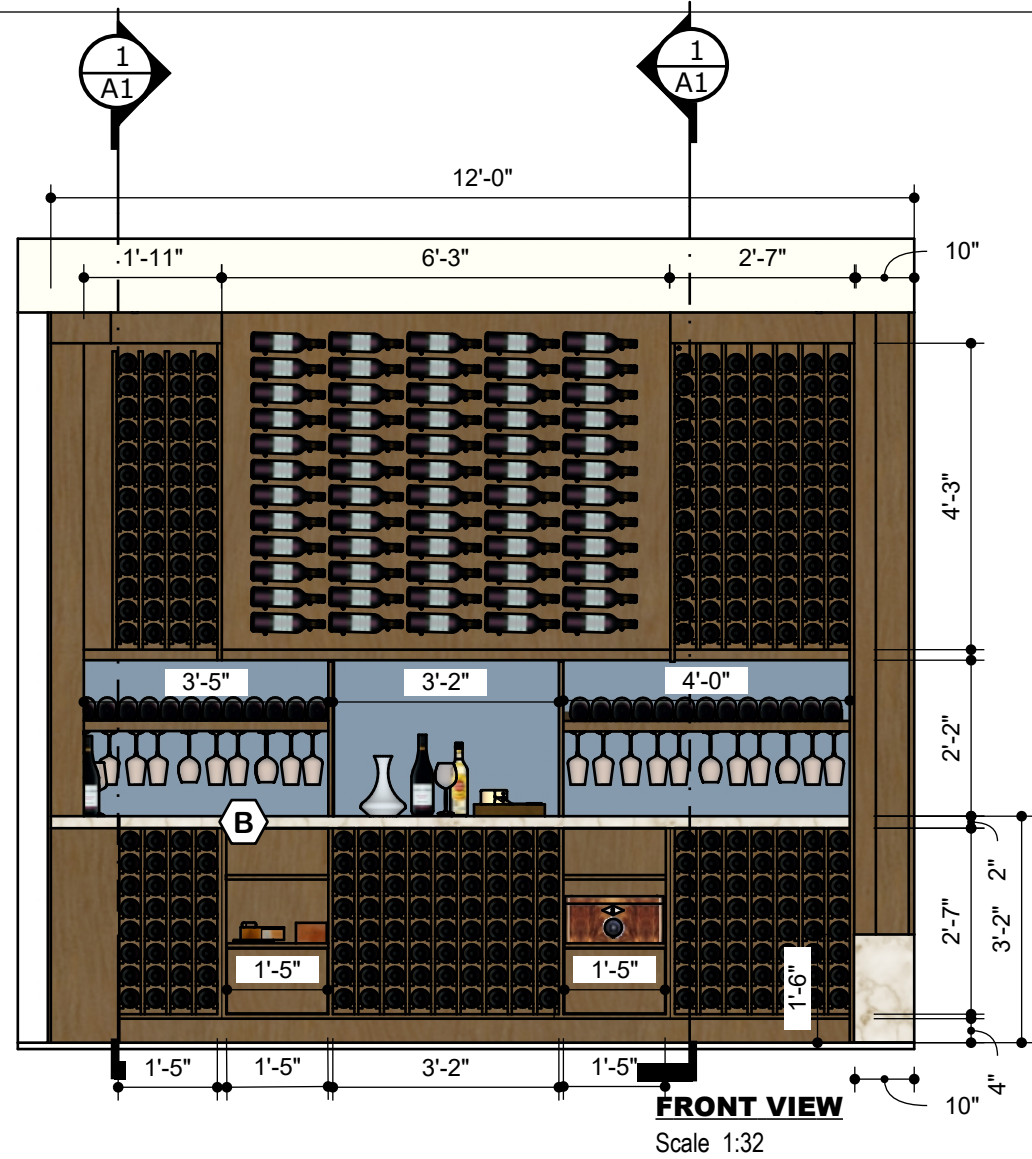

**PROGRESS DRAWING**

**ALL MEASUREMENTS MUST BE VERIFIED IN FIELD**  
This drawing is not intended to be used for contract pricing or fabrication purposes. All content is subject to change.

**DISCARD ALL DRAWINGS THAT WERE MADE ON THIS ITEM PRIOR TO THE DATE BELOW:**  
**02/8/2022**

**NOTES**  
Drawings may not be scaled. The numerical dimensions represent correct measurements. All dimensions are given from finished floor and finished wall unless otherwise noted.  
All design ideas, drawings and plans represented here are owned by the property of **WESTHAVEN CONSTRUCTION SERVICES, INC.**  
All rights reserved. Above suggested electrical and plumbing locations, must be verified in field.

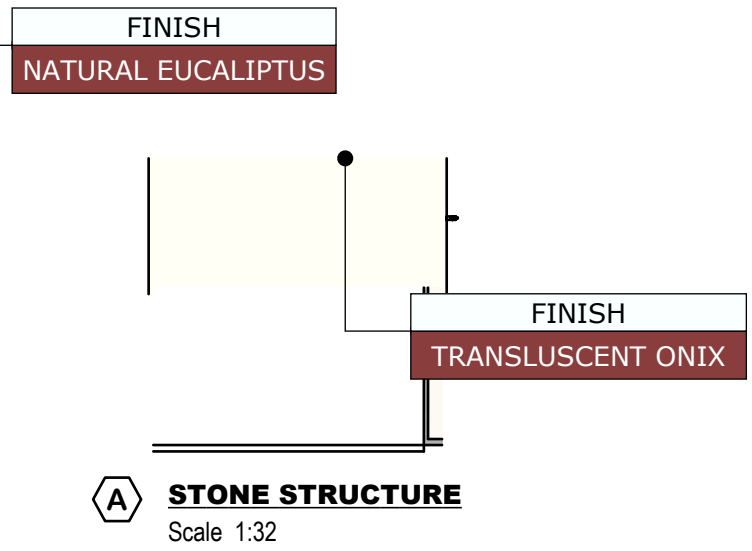

**WESTHAVEN**  
CONSTRUCTION SERVICES, INC.

**CLIENT**  
J&Y  
0000  
FL, 33000

**ISSUE**  
12/21/2021  
**RE - ISSUE**  
MM, DD, YY

**DESIGN BY**  
Joel A.  
**DRAWN BY**  
Abel Q.

**DESCRIPTION**  
WINE CELLAR  
**PAGE NAME**  
PLANS

**PROJECT No**  
3701  
**PROJECT NAME**  
MIRAMAR