



Specifications for Project

450 ALTON ROAD

WESTHAVEN CONSTRUCTION SERVICES.INC, ROGER

Salesperson

Arnoldo Gurdian

arnoldo.gurdian@fuseappliances.com



REMINDER:

To ensure a smooth project it is the responsibility of the homeowner / purchaser of appliances for this project to share all the attached specifications to ensure the cabinet provider, contractor, or any other tradesperson have all the information required to complete their work accurately.

Specifications are subject to change. If any tradesperson has questions regarding the attached specifications please contact our sales associate.

450 ALTON ROAD

WESTHAVEN CONSTRUCTION SERVICES.INC, ROGER

450 ALTON ROAD

ICON UNIT # 3203

Miami Beach, FL 33139



Fuse Specialty Appliances

fuseappliances.com

Arnoldo Gurdian

Account Manager

3054914213

Quote **MI42500093**

Version 1.1

Wed, Aug 6, 2025

11:26 AM EDT



enterprise.steelcod.com/sp/fuse/SLAHAUK4

<i>Contents</i>	<i>Page no.</i>
DEC3050R/R Sub-Zero Refrigeration 30" Designer Column Refrigerator - Panel Ready - Right Hinge	4-8
DEC1850FI/L Sub-Zero Refrigeration 18" Designer Column Freezer with Ice Maker - Panel Ready - Left Hinge	9-13
SPO30TE/S/TH Wolf Wall Oven 30" E Series Transitional Speed Oven	14-17
SO3050TE/S/T Wolf Wall Oven 30" E Series Transitional Built-In Single Oven	18-21
CI304TF/S Wolf Cooktop 30" Transitional Framed Induction Cooktop	22-23
FIVAL28B5SS-R	24-25

Note about page numbers:

Because the original manufacturer's documents are not altered in any way, the page numbers displayed on the page may not correspond to the page number within this package.

All specifications are intended for initial planning purposes only.

Manufacturers reserve the right to change specifications at any time without notice. Always consult the installation instructions found on the manufacturer's website or included with the appliances before installation.

Falmec Ventilation

G 7193 SCVi	26-27
Miele Dishwasher	
24" Fully Integrated Panel-Ready Dishwasher (ADA)	
SKU: 12496700	

HH24WS-4-4L	28-32
Perlick Refrigeration	
24" Signature Series Shallow Depth Wine Reserve	

DEU2450R/R	33-36
Sub-Zero Refrigeration	
24" Designer Undercounter Refrigerator - Panel Ready	

Note about page numbers:
Because the original manufacturer's documents are not altered in any way, the page numbers displayed on the page may not correspond to the page number within this package.

All specifications are intended for initial planning purposes only.
Manufacturers reserve the right to change specifications at any time without notice. Always consult the installation instructions found on the manufacturer's website or included with the appliances before installation.

DEC3050R



FEATURES

Split Climate® intelligent cooling system revolutionizes Sub-Zero's already-superior preservation capabilities, keeping food even fresher for longer

ClearSight™ LED lighting system fully illuminates the interior and reduces shadows

Sleek stainless accents trim the interior, matching the sophistication of the exterior

Easily customize settings—from lighting to humidity—with the tap of a finger via the conveniently accessible touch control panel

Night Mode optimizes the interior lighting based on the detected ambient light, reducing the brightness by 90% in dim environments

Lift the base of the flip-up dairy compartment to store taller items on the shelf below

Position adjustable door shelves at various heights to accommodate assorted items

Nano coating lines the perimeter of each glass shelf to create a hydrophobic barrier that helps contain spills

The easily accessible NASA-inspired air purification system scrubs the air of ethylene and odor every 20 minutes

Wi-Fi enabled for convenient remote access using your mobile device or smart home system

Sub-Zero offers an industry-leading full two-year warranty on appliances, along with a full five-year sealed system warranty

Accepts custom panels for an integrated look within cabinetry or stainless-steel accessory panels and handles to match other Sub-Zero, Wolf, and Cove products*

ACCESSORIES

Air Purification Cartridge

Egg Container

Reduced Toekick Divider

Stainless Steel Side Panel

Dual Installation Kits

Stainless Steel Dual Installation Kickplates

Stainless Steel Door Panels With Pro Handle

Stainless Steel Door Panels With Tubular Handle

Stainless Steel Pro and Tubular Handles

Accessories are available through an authorized dealer.
For local dealer information, visit subzero-wolf.com/locator.



HANDLE ACCESSORIES

PRO



TUBULAR



PRODUCT DETAILS

REFRIGERATOR

- LED refrigerator lights
- 4 glass refrigerator shelves (3 adjustable; 1 stationary)
- 4 soft-close crisper drawers with adjustable dividers
- 5 door bins (3 adjustable; 2 stationary)
- 1 flip-up dairy compartment

PRODUCT SPECIFICATIONS

Model	DEC3050R
Dimensions	30"W x 84"H x 24"D
Refrigerator Capacity	17.5 cu. ft.
Weight	425 lbs
Electrical Supply	115 VAC, 60 Hz
Electrical Service	15 amp dedicated circuit

ELECTRICAL

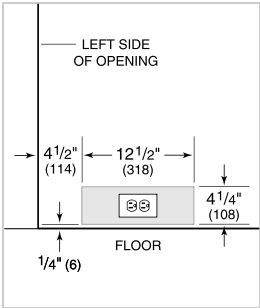

NOTE: The electrical outlet must be positioned with the grounding prong to the right of the thinner blades.

PANEL SPECIFICATIONS For complete panels specifications including width/height, weight requirements and thickness requirements visit subzero-wolf.com/reveal.

NOTE: Dimensions in parenthesis are in millimeters unless otherwise specified

INTERIOR VIEW

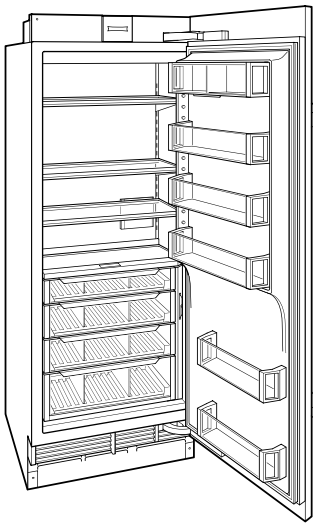

This illustration is intended for interior reference only and may not represent the exterior of the model being specified.

DIMENSIONS

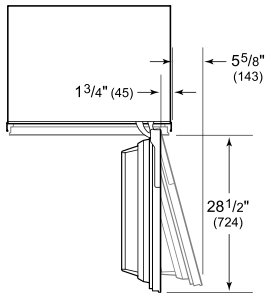
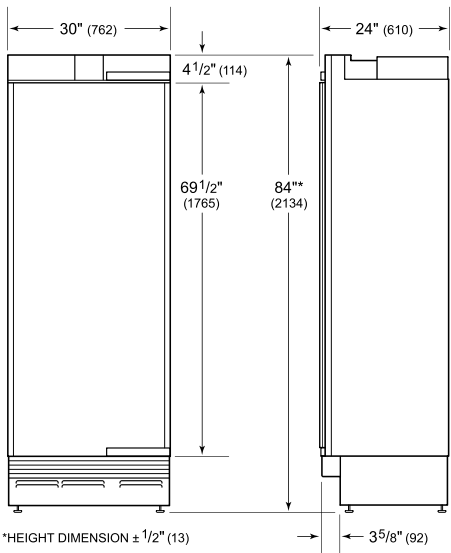

STANDARD INSTALLATION

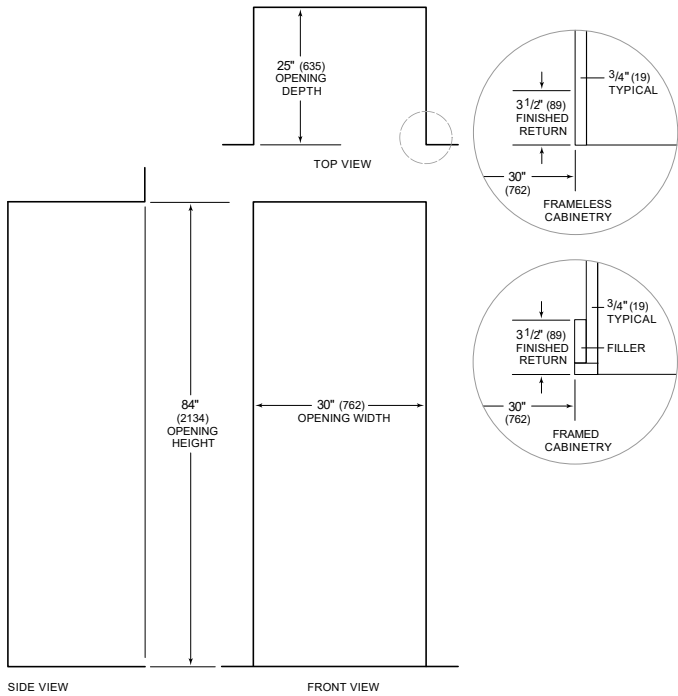

NOTE: 3 1/2" (89) finished returns will be visible and should be finished to match cabinetry

Panel Specifications

Single Model: DEC3050R

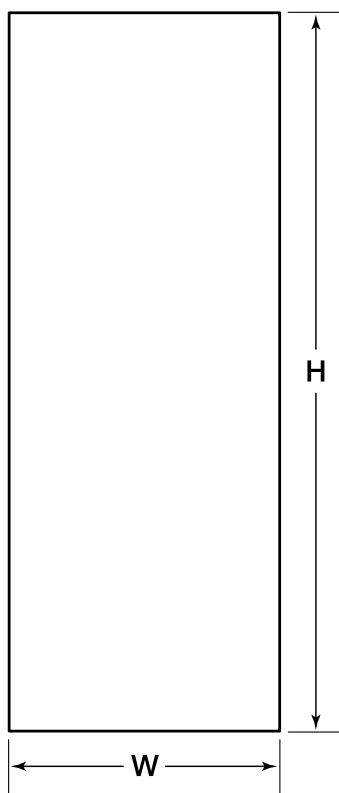

PANEL	WIDTH	HEIGHT	MIN THICKNESS	MAX WEIGHT
Door	29 ³ / ₄ "	79 ⁷ / ₈ "	⁵ / ₈ "	75 lbs

PLEASE NOTE: Panel specs change slightly when units are combined. Visit <https://www.subzero-wolf.com/trade-resources/reveal> for exact dimensions.

Panel Planning Notes

Single Model: DEC3050R

For designer models, custom door panels and handle hardware must be provided.

The thickness of the custom panel can vary. A minimum 5/8" (16) thick panel is required, but the thickness can be increased provided it does not exceed the weight limit.

The depth of each designer model is 24" (610). Allow for panel thickness when planning the finished opening depth.

D-style handles are recommended. Door handles must be located near the edge of the panel opposite the hinge and should be centered top to bottom.

Typical panel dimensions are based on an 84" (2134) finished height for column and tall models and 1/8" (3) reveals. Panel dimensions must be adjusted accordingly for all other installations. Finish all sides of custom panels. They will be visible when the door/drawer is open.

Stainless steel tubular and pro handles are available through an authorized Sub-Zero dealer.

Minimum Panel Thickness

5/8"

Standard Handle Lengths (Optional)

HANDLE	TUBULAR	PRO
DEC3050R Door	50 1/8"	48 3/8"

Door Panel Height

Typical panel dimensions are based on an 84" (2134) finished height for column and tall models and 34 1/2" (876) for drawer models, with a 4" (102) toe kick and 1/8" (3) reveals. Panel dimensions must be adjusted accordingly for all other installations.

The height of the custom door panel can extend beyond the typical panel height, provided it does not exceed the weight limit.

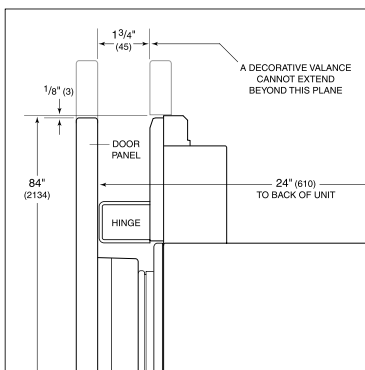

Upper valance—column and tall (side view).

Toe Kick Clearance

The height of the toe kick area can extend beyond the typical toe kick height, provided it does not exceed the dimensions in the illustration below. Toe kick heights from 2" (51) to 3 7/8" (98) require a reduced toe kick accessory available through an authorized Sub-Zero dealer.

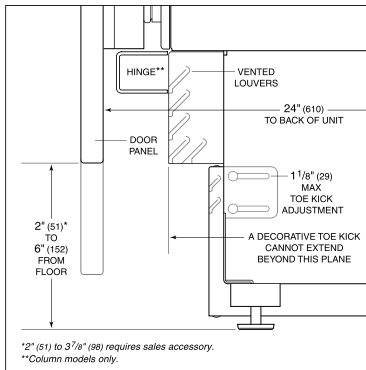

Toe kick (side view).

DEC1850FI



FEATURES

ClearSight™ LED lighting system fully illuminates the interior and reduces shadows

Sleek stainless accents trim the interior, matching the sophistication of the exterior

Easily customize settings with the tap of a finger via the conveniently accessible touch control panel

Night Mode optimizes the interior lighting based on the detected ambient light, reducing the brightness by 90% in dim environments

Position adjustable door shelves at various heights to accommodate assorted items

Fresh-tasting, filtered ice ready on demand; activate Max Ice Mode to temporarily increase ice production

Locks in cold air with a magnetic door seal system

Wi-Fi enabled for convenient remote access using your mobile device or smart home system

Sub-Zero offers an industry-leading full two-year warranty on appliances, along with a full five-year sealed system warranty

Accepts custom panels for an integrated look within cabinetry or stainless-steel accessory panels and handles to match other Sub-Zero, Wolf, and Cove products*

ACCESSORIES

Reduced Toekick Divider

Stainless Steel Side Panel

Water Filter

Dual Installation Kits

Stainless Steel Dual Installation Kickplates

Stainless Steel Door Panels With Pro Handle

Stainless Steel Door Panels With Tubular Handle

Stainless Steel Pro and Tubular Handles

Accessories are available through an authorized dealer. For local dealer information, visit subzero-wolf.com/locator.



HANDLE ACCESSORIES

PRO



TUBULAR



PRODUCT DETAILS

FREEZER

- LED freezer lights
- 4 freezer shelves (3 adjustable; 1 stationary)
- 2 storage drawers
- 5 adjustable door bins
- Ice drawer with automatic ice maker

PRODUCT SPECIFICATIONS

Model	DEC1850FI
Dimensions	18"W x 84"H x 24"D
Freezer Capacity	8.8 cu. ft.
Weight	285 lbs
Electrical Supply	115 VAC, 60 Hz
Electrical Service	15 amp dedicated circuit
Plumbing Supply	1/4" OD copper, braided stainless steel or PEX tubing
Plumbing Pressure	35–120 psi

ELECTRICAL

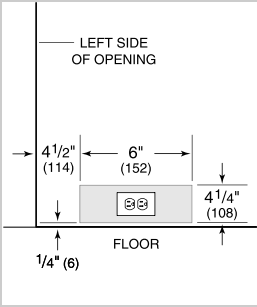

PLUMBING

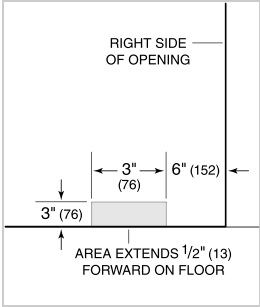

NOTE: The electrical outlet must be positioned with the grounding prong to the right of the thinner blades.

PANEL SPECIFICATIONS For complete panels specifications including width/height, weight requirements and thickness requirements visit subzero-wolf.com/reveal.

NOTE: Dimensions in parenthesis are in millimeters unless otherwise specified

INTERIOR VIEW

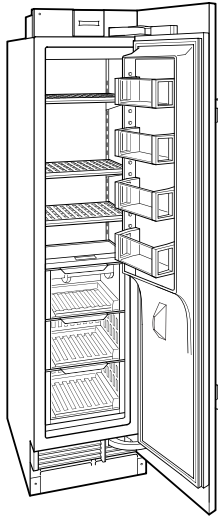

This illustration is intended for interior reference only and may not represent the exterior of the model being specified.

DIMENSIONS

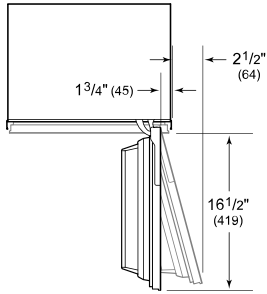
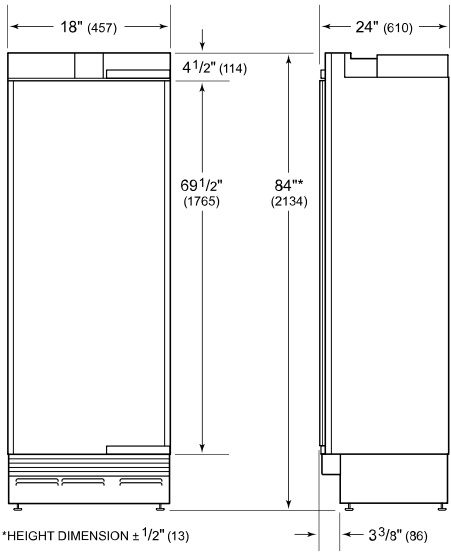

STANDARD INSTALLATION

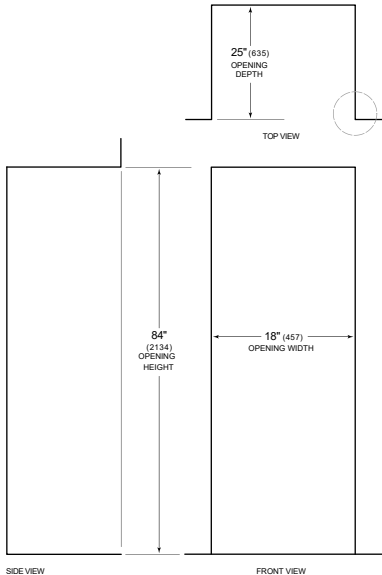

NOTE: 3 1/2" (89) finished returns will be visible and should be finished to match cabinetry.

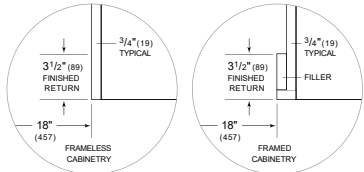

Panel Specifications

Single Model: DEC1850FI

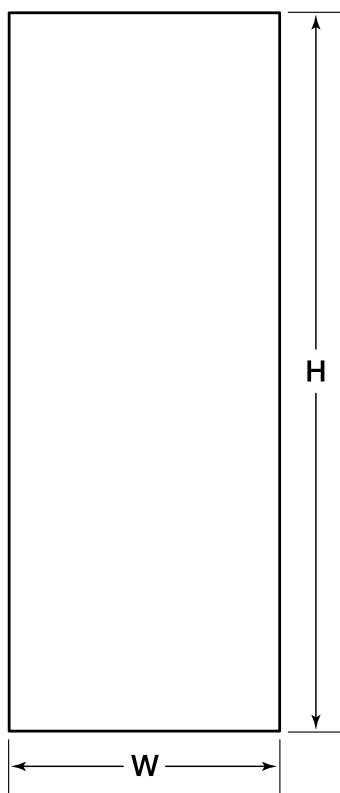

PANEL	WIDTH	HEIGHT	MIN THICKNESS	MAX WEIGHT
Door	17 ³ / ₄ "	79 ⁷ / ₈ "	⁵ / ₈ "	45 lbs

PLEASE NOTE: Panel specs change slightly when units are combined. Visit <https://www.subzero-wolf.com/trade-resources/reveal> for exact dimensions.

Panel Planning Notes

Single Model: DEC1850FI

For designer models, custom door panels and handle hardware must be provided.

The thickness of the custom panel can vary. A minimum 5/8" (16) thick panel is required, but the thickness can be increased provided it does not exceed the weight limit.

The depth of each designer model is 24" (610). Allow for panel thickness when planning the finished opening depth.

D-style handles are recommended. Door handles must be located near the edge of the panel opposite the hinge and should be centered top to bottom.

Typical panel dimensions are based on an 84" (2134) finished height for column and tall models and 1/8" (3) reveals. Panel dimensions must be adjusted accordingly for all other installations. Finish all sides of custom panels. They will be visible when the door/drawer is open.

Stainless steel tubular and pro handles are available through an authorized Sub-Zero dealer.

Minimum Panel Thickness

5/8"

Standard Handle Lengths (Optional)

HANDLE	TUBULAR	PRO
DEC1850FI Door	50 1/8"	48 3/8"

Door Panel Height

Typical panel dimensions are based on an 84" (2134) finished height for column and tall models and 34 1/2" (876) for drawer models, with a 4" (102) toe kick and 1/8" (3) reveals. Panel dimensions must be adjusted accordingly for all other installations.

The height of the custom door panel can extend beyond the typical panel height, provided it does not exceed the weight limit.

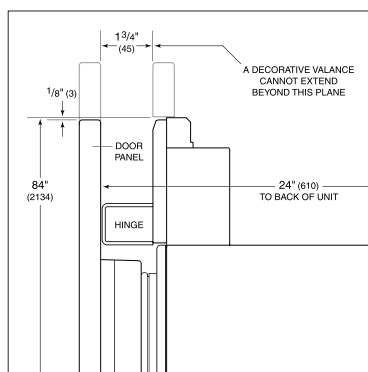

Upper valance—column and tall (side view).

Toe Kick Clearance

The height of the toe kick area can extend beyond the typical toe kick height, provided it does not exceed the dimensions in the illustration below. Toe kick heights from 2" (51) to 3 7/8" (98) require a reduced toe kick accessory available through an authorized Sub-Zero dealer.

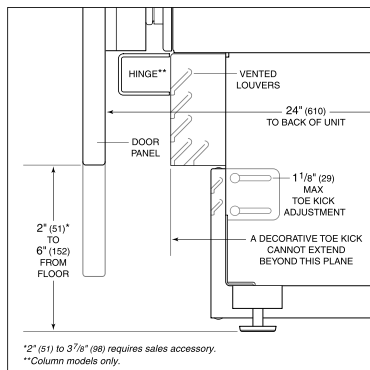

Toe kick (side view).

SPO30TE/S/TH**FEATURES**

Combines microwave, convection, and broil technologies to provide all-in-one oven versatility

Provides more cooking power than a traditional microwave with the help of convection and broil

Assures predictably delicious results with 10 microwave power levels, convenient quick-start modes, and an intuitive Gourmet mode

Fits a 9-by-13 pan in the 1.6 cubic feet, stainless-steel interior

Micro Bake and Micro Roast modes reduce or completely eliminate preheat times

Frees up counter space with efficient drop-down door design

Coordinates with other Wolf built-in ovens and appliances with various handle and trim options

Master your technique with tips and recipes from the Mastering the Speed Oven guide





PRODUCT SPECIFICATIONS

Model	SPO30TE/S/TH
Dimensions	29 7/8"W x 17 7/8"H x 21 1/2"D
Capacity	1.6 cu. ft.
Door Clearance	14 3/16"
Weight	82 lbs
Electrical Supply	grounded, 240/208 VAC, 60Hz
Electrical Service	15 amp dedicated circuit
Power Cord Length	6 Feet
Receptacle	NEMA 6-20R grounding type

ELECTRICAL

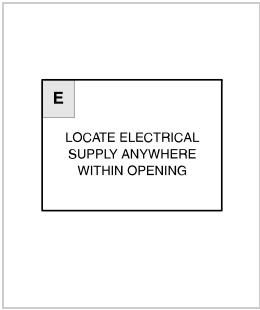

NOTE: Dimensions in parenthesis are in millimeters unless otherwise specified

DIMENSIONS

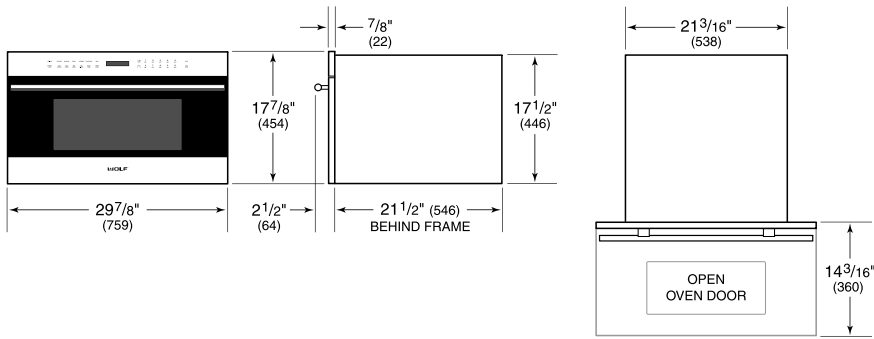

FLUSH INSTALLATION

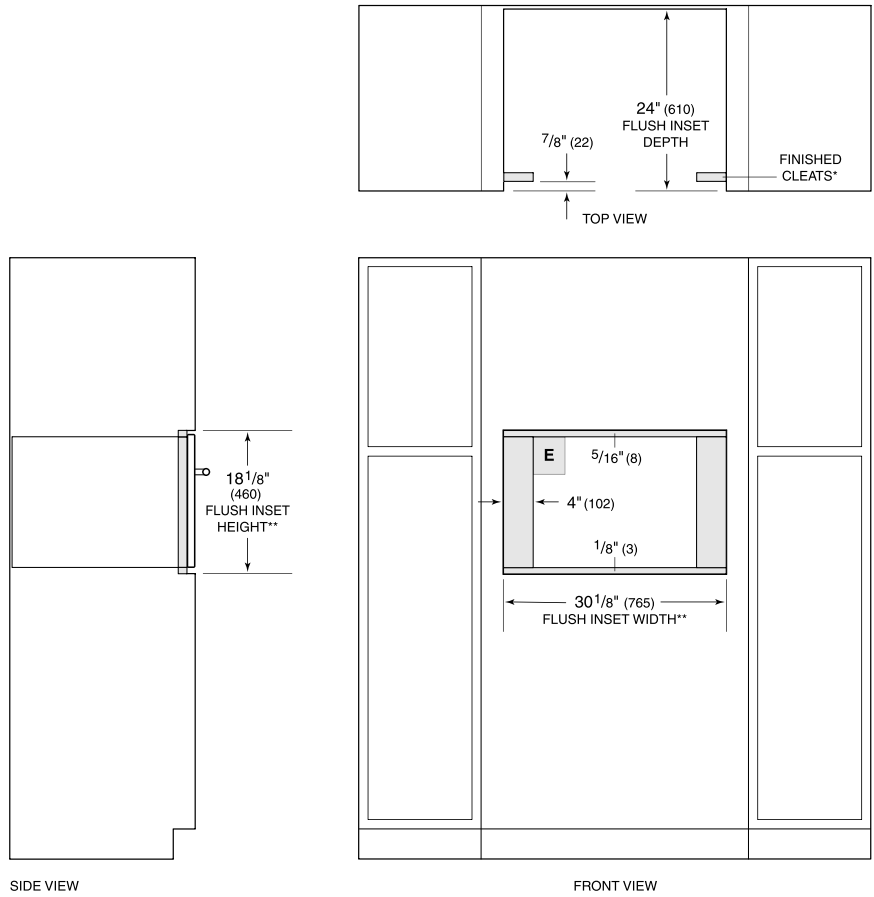

*Will be visible and should be finished to match cabinetry.
**Dimension provides minimum reveals.

SPO30TE/S/TH**FEATURES**

Combines microwave, convection, and broil technologies to provide all-in-one oven versatility

Provides more cooking power than a traditional microwave with the help of convection and broil

Assures predictably delicious results with 10 microwave power levels, convenient quick-start modes, and an intuitive Gourmet mode

Fits a 9-by-13 pan in the 1.6 cubic feet, stainless-steel interior

Micro Bake and Micro Roast modes reduce or completely eliminate preheat times

Frees up counter space with efficient drop-down door design

Coordinates with other Wolf built-in ovens and appliances with various handle and trim options

Master your technique with tips and recipes from the Mastering the Speed Oven guide





PRODUCT SPECIFICATIONS

Model	SPO30TE/S/TH
Dimensions	29 7/8"W x 17 7/8"H x 21 1/2"D
Capacity	1.6 cu. ft.
Door Clearance	14 3/16"
Weight	82 lbs
Electrical Supply	grounded, 240/208 VAC, 60Hz
Electrical Service	15 amp dedicated circuit
Power Cord Length	6 Feet
Receptacle	NEMA 6-20R grounding type

ELECTRICAL

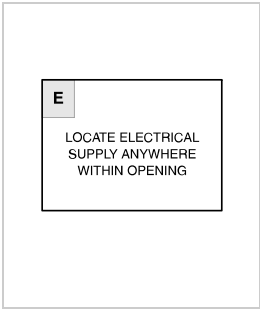

NOTE: Dimensions in parenthesis are in millimeters unless otherwise specified

DIMENSIONS

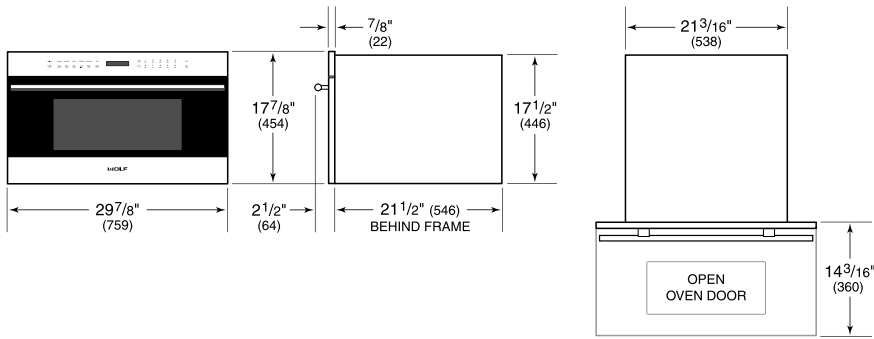

STANDARD INSTALLATION

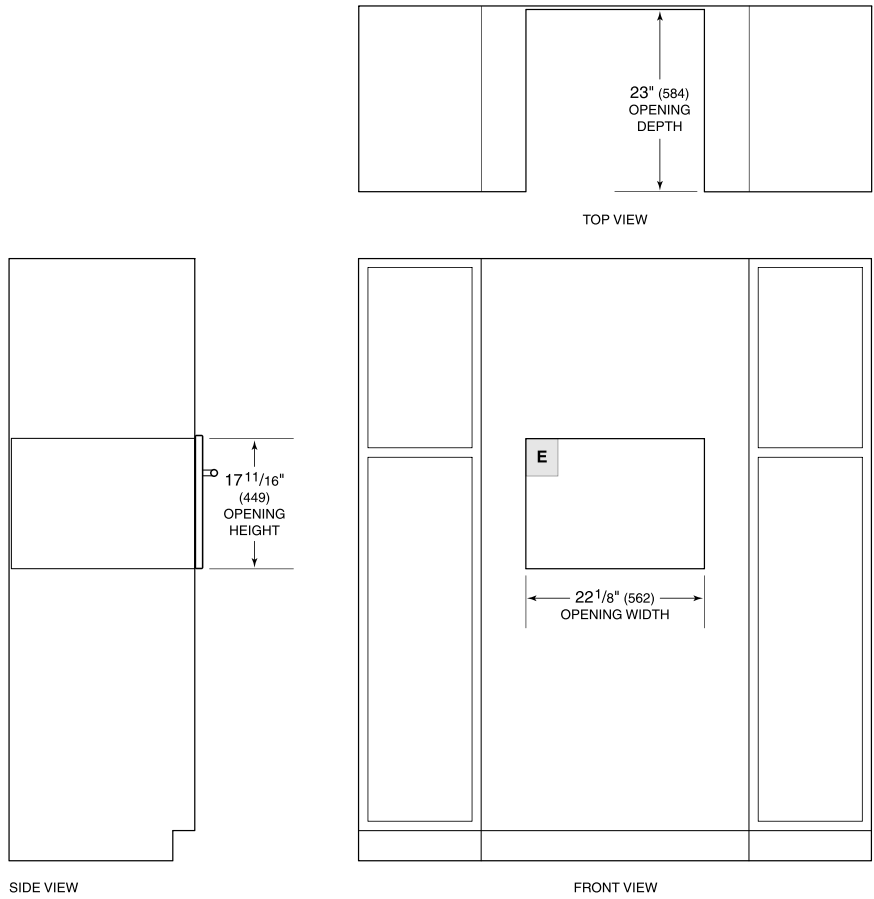

NOTE: 24" (610) and 30" (762) models require the same opening dimensions.



SO3050TE/S/T



FEATURES

Wolf's dual convection system provides reliably even heat, reduces hot and cold spots, and enables consistent multi-rack cooking

Take the guesswork out of cooking with 10 chef-created cooking modes, including Bake, Broil, Convection, Convection Roast, Dehydrate, Gourmet, Proof, Roast, Stone, and Warm

Gourmet Mode offers nearly 50 presets to automatically cook a delicious set of impressive dishes

The large full-color touchscreen and stainless touch controls are intuitive and easy-to-read

The temperature probe alerts you when your dish has reached the desired temperature

The oven offers self-clean, delayed start, timed cook, and Sabbath features

Control your oven from wherever you are using our convenient Owner's App—remotely preheat, adjust temperatures, select modes, and more

Coordinates with other Sub-Zero, Wolf, and Cove appliances to create a cohesive look in your kitchen

Get the most out of your oven with tips and recipes from the Mastering the E Series Oven guide

ACCESSORIES

30" Broiler Pan and Rack

30" Premier Baking Sheet

30" Standard Oven Rack

Bake Stone Kit

Dehydration Kit

Dual Installation Kit

Full-Extension Ball-Bearing Rack

Standard Oven Rack

Temperature Probe

Accessories available through an authorized dealer.
For local dealer information, visit subzero-wolf.com/locator.





SO3050TE/S/T



FEATURES

Wolf's dual convection system provides reliably even heat, reduces hot and cold spots, and enables consistent multi-rack cooking

Take the guesswork out of cooking with 10 chef-created cooking modes, including Bake, Broil, Convection, Convection Roast, Dehydrate, Gourmet, Proof, Roast, Stone, and Warm

Gourmet Mode offers nearly 50 presets to automatically cook a delicious set of impressive dishes

The large full-color touchscreen and stainless touch controls are intuitive and easy-to-read

The temperature probe alerts you when your dish has reached the desired temperature

The oven offers self-clean, delayed start, timed cook, and Sabbath features

Control your oven from wherever you are using our convenient Owner's App—remotely preheat, adjust temperatures, select modes, and more

Coordinates with other Sub-Zero, Wolf, and Cove appliances to create a cohesive look in your kitchen

Get the most out of your oven with tips and recipes from the Mastering the E Series Oven guide

ACCESSORIES

30" Broiler Pan and Rack

30" Premier Baking Sheet

30" Standard Oven Rack

Bake Stone Kit

Dehydration Kit

Dual Installation Kit

Full-Extension Ball-Bearing Rack

Standard Oven Rack

Temperature Probe

Accessories available through an authorized dealer.
For local dealer information, visit subzero-wolf.com/locator.





PRODUCT SPECIFICATIONS

Model	SO3050TE/S/T
Dimensions	29 7/8"W x 28 1/2"H x 23"D
Oven 1 Interior Dimensions	25 1/4"W x 17 1/2"H x 18 1/2"D
Overall Capacity	4.7 cu. ft.
Usable Capacity	3.1 cu. ft.
Door Clearance	21 3/8"
Weight	257 lbs
Electrical Supply	grounded, 240/208 VAC, 60 Hz
Electrical Service	30 amp dedicated circuit
Conduit Length	4 Feet

ELECTRICAL

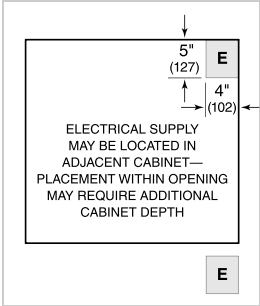

NOTE: Dimensions in parenthesis are in millimeters unless otherwise specified

DIMENSIONS

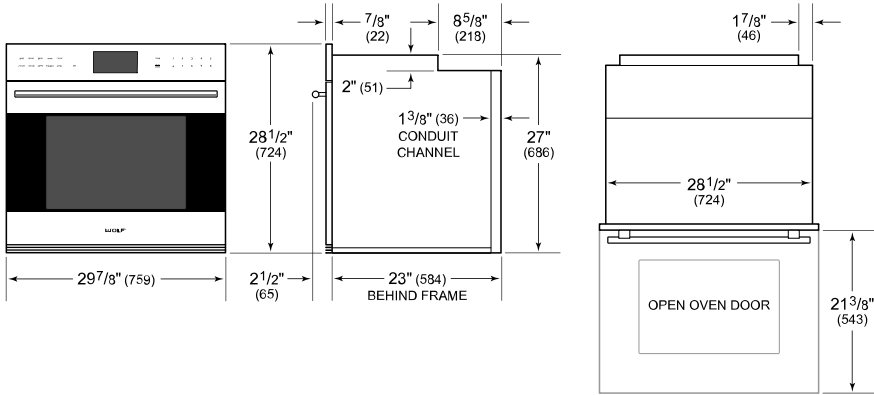

STANDARD INSTALLATION

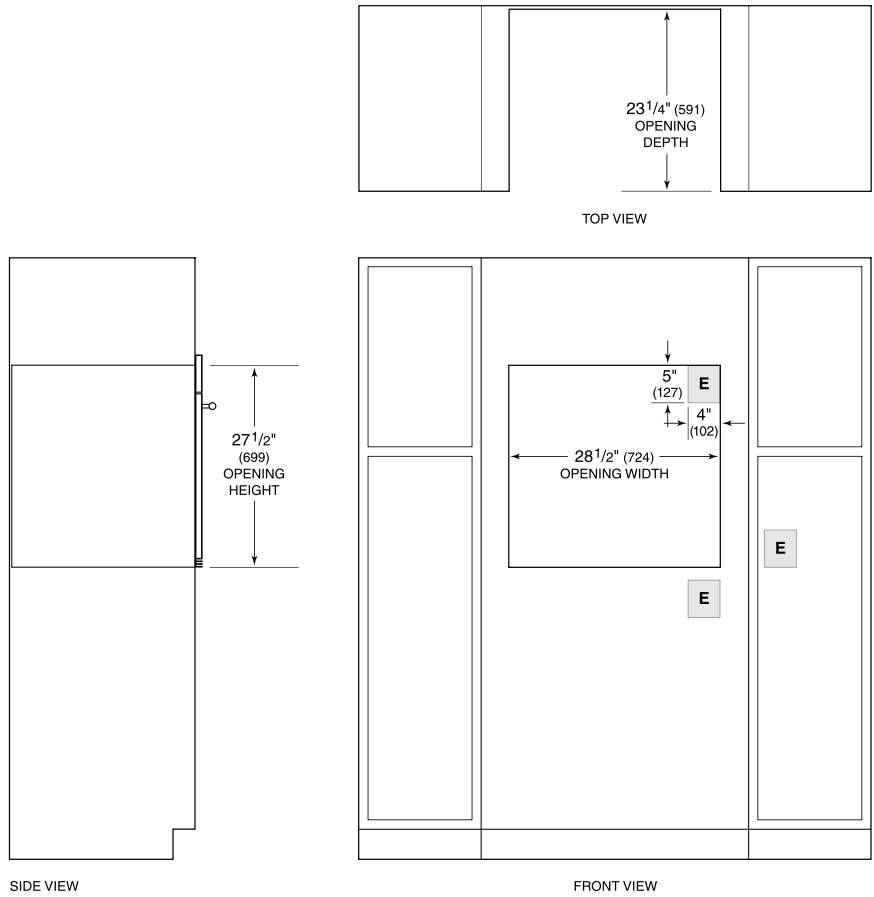

NOTE: Location of electrical supply within opening may require additional cabinet depth.

CI304TF/S**FEATURES**

Distributes heat more evenly with 40 percent faster temperature response than gas or electric

Transfers heat more efficiently because the energy is supplied directly to the cookware

Enjoy cooking with lightning-fast highs and subtle lows

Pair our slim 15" width with other Wolf modules for an integrated design

The Bridge function joins two induction zones into one large area, enabling use of an induction-capable griddle, open roaster, or fish poacher

Promote safer and easier cooking with cookware sensing guards

Cleanup is a snap with the black ceramic glass surface

Enjoy the illuminated touch controls and convenient lock feature

ACCESSORIES

Cooktop/Module Filler Strip

Cooktop/Module Filler Strip for Downdrafts

Accessories available through an authorized dealer.

For local dealer information, visit subzero-wolf.com/locator.

**COOKTOP SPECIFICATIONS**

- Brushed stainless trim
- Black ceramic glass surface
- True simmer and melt settings
- Boost Mode for high heat
- 1 - 1,400 W element
- 1 - 2,100 W element
- 1 - 2,100 W element with 3,700 W boost
- 1 - 2,600 W element with 3,700 W boost



PRODUCT SPECIFICATIONS

Model	CI304TF/S
Dimensions	30"W x 2"H x 21"D
Weight	49 lbs
Electrical Supply	3-wire, 240/208 VAC, 60 Hz
Electrical Service	40 amp dedicated circuit
Conduit Length	4 Feet

ELECTRICAL

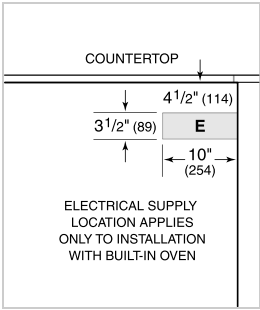

NOTE: Dimensions in parenthesis are in millimeters unless otherwise specified

DIMENSIONS

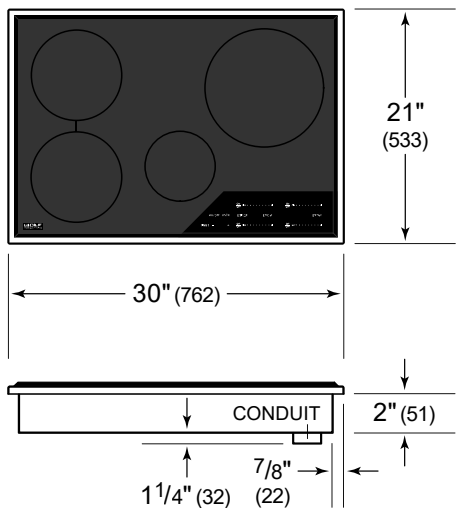

STANDARD INSTALLATION

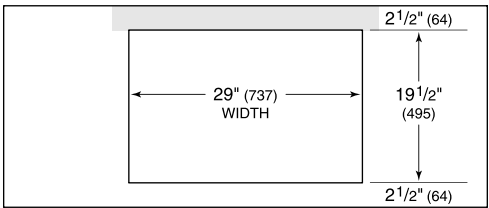

COUNTERTOP CUT-OUT

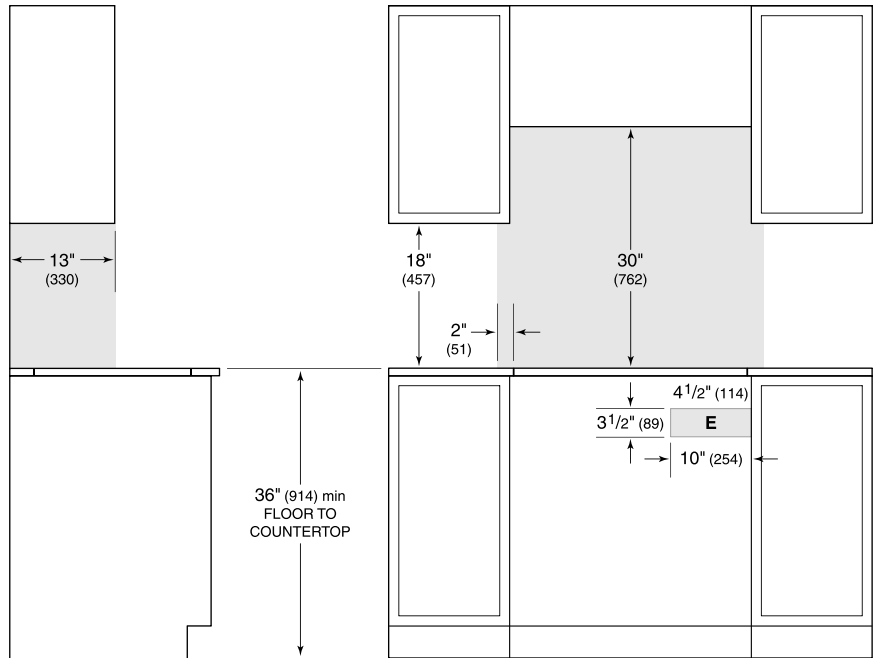

SIDE VIEW

FRONT VIEW

NOTE: Shaded area above countertop indicates minimum clearance to combustible surfaces, combustible materials cannot be located within this area.
Electrical supply location only applies to installations with built-in oven.

VALENTINA

Version
FIVAL28B5SS-R/ Built-in – 28"
(70 cm) 500 CFM

Collection
Potenza

EAN code
8034122343358



Photograph is for information purposes only
May not correspond to the selected version

FEATURES

- Perimeter suction
- Electronic control
- LED lighting
- Metallic grease filter, removable and washable
- Optional charcoal filter
- Optional remote control
- Scotch brite stainless steel
- SRS Speed reduction system

Cut-out size: 10 5/16" (262) x 26 1/4" (666)

Recommended mounting height from cooking surface to hood bottom: 24" - 36"

OPTIONAL ACCESSORIES

- FFCHAR3C0BL**
FFCHAR3C0BL - Round charcoal filter Ø 6' - Type 6
- KACL.815**
Protective cleaning cloths for stainless steel (box 10 pcs)
- 105080053**
Remote control

TECHNICAL FEATURES

- Installation type**
Built-in
- Dimensions**
28 / 72 cm
- Finish**
Scotch brite stainless steel
- Motor**
500 CFM
- Type of control**
Electronic control
- Speed settings**
4
- Lighting**
Led 2x1,2 W - 3200 K
- Charcoal filter**
FFCHAR3C0BL - Round charcoal filter Ø 6' - Type 6 (optional)
- Minimum distance**
Gas hob: 25 in
Electric hob: 21 in

PACKAGING:WEIGHTS AND VOLUMES

- Gross weight**
31 lbs
- Net weight**
27 lbs
- Volumes**
4 ft³
- Packaging size**
Length
32 in
Height
15 in
Depth
16 in

CONSUMPTION AND CONNECTION FEATURES

- Maximum consumption**
280 W
- Plug type**
Hood comes standard with Nema 5-15P power cord
- ENERGY CLASS**

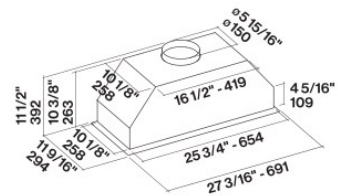

VALENTINA 28" Cod.: FIVAL28B5SS-1

12 kg
26,4 lb

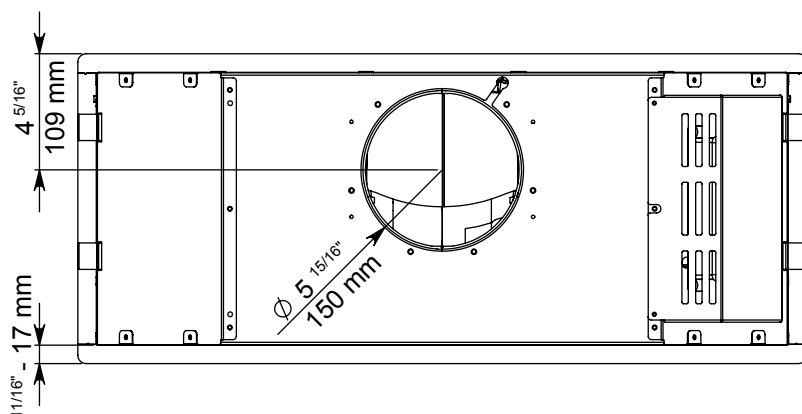
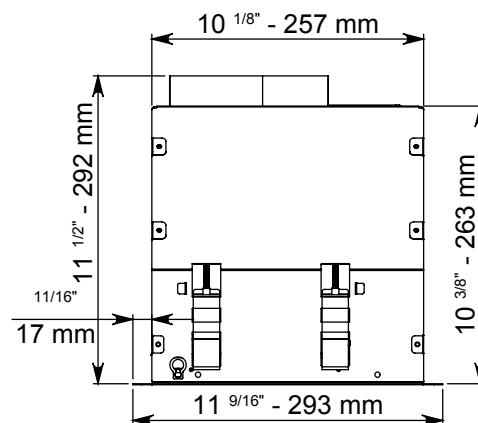
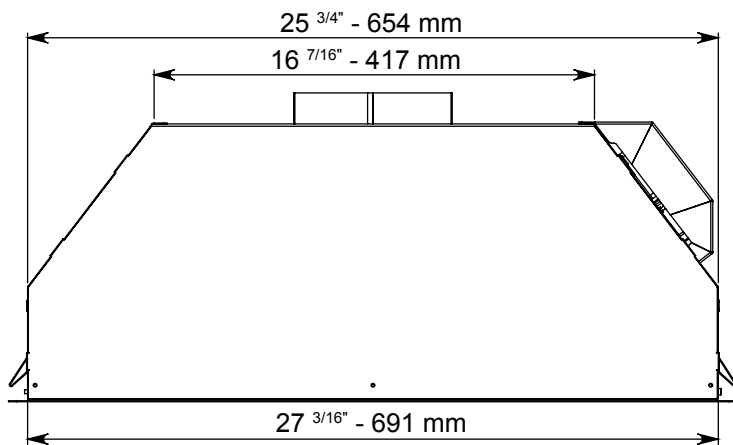

Cutout dimensions

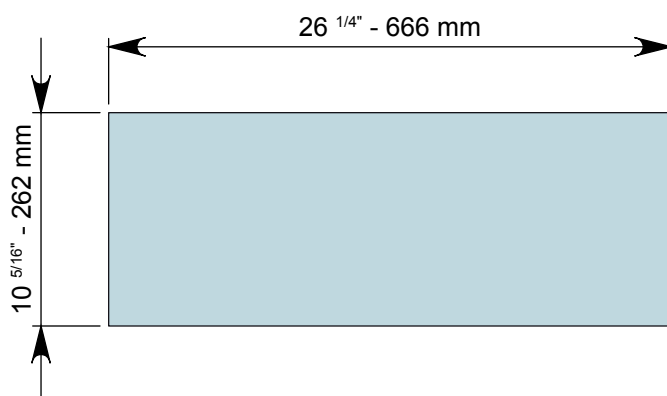

120VAC 60Hz 280W

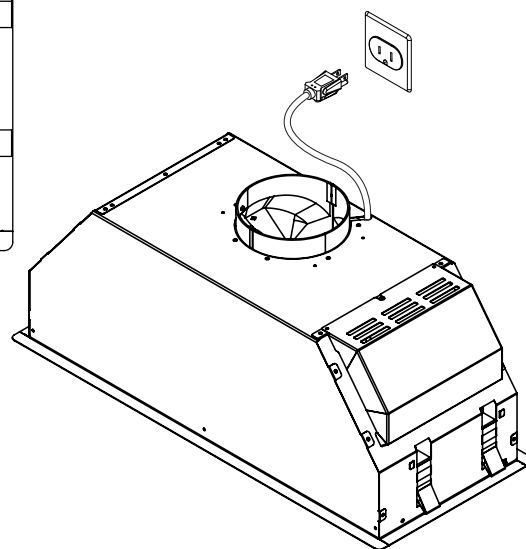

EN- cable length 5,0ft (1,5m)
FR- longueur de câble 5,0ft (1,5m)
ES- longitud de cable 5,0ft (1,5m)
IT- lunghezza cavo 5,0ft (1,5m)

EN - MEASUREMENTS FOR INSTALLATION
FR - MESURES DU TROU POUR ENCASTREMENT
ES - MEDIDAS DEL ORIFICIO PARA EMPOTRADO
IT - MISURE FORO PER INCASSO

EN- tool required
FR- outil requis
ES- herramienta requerida
IT - Attrezzi necessari



G 7193 SCVi

24" Fully Integrated Panel-Ready Dishwasher (ADA)

Features:

- DirectSelect Controls
- ExtraComfort Baskets
- 3D MultiFlex Cutlery Tray
- EcoPower Technology
- Whisper quiet 42 dB(A)
- AutoDos with PowerDisk
- WifiConn@ct
- QuickIntenseWash - 58 min. program
- SaniWash - Sanitize cycle
- ExtraClean & ExtraDry Options to customize wash programs
- Delayed Start
- Water Softener
- EnergyStar



MATERIAL

12496700

SPECIFICATIONS	
Overall Unit Dimensions	23 ⁹ / ₁₆ " (598 mm) W x 32 ¹ / ₁₆ " - 34 ¹ / ₄ " (814 - 870 mm) H x 22 ⁷ / ₁₆ " (570 mm) D [Depth does not include door panel]
Niche	
Minimum Cabinet Niche Opening	23 ⁵ / ₈ " (600 mm) W x 32 ¹ / ₈ " (814 mm) H x 22 ⁷ / ₁₆ " (570 mm) D
Plumbing	
Water Supply Requirements	<ul style="list-style-type: none"> • Cold or Hot (max 150°F/65°C) water connection • Male 3/8" compression fitting • Water pressure range 7.25 psi (0.5 bar) and 145 psi (10 bar)
Water Connection Line (Supplied)	Length: 5 ft (1.5 m) Female 3/8" compression.
Drain Hose (Supplied)	Length: 5 ft (1.5 m) 7/8" (22 mm) internal diameter
Electrical	
Electrical Requirements	110V / 120V, 60Hz, 15 Amps
Power Cord (Convertible to hardwire)	NEMA 5-15 plug, 5 ft (1.52 m)
Shipping	
Shipping Weight	121 lbs (55 kg)
Shipping Dimensions	27 ¹ / ₈ " W x 38 ¹ / ₈ " H x 26 ³ / ₈ " D

PRODUCT DIMENSIONS

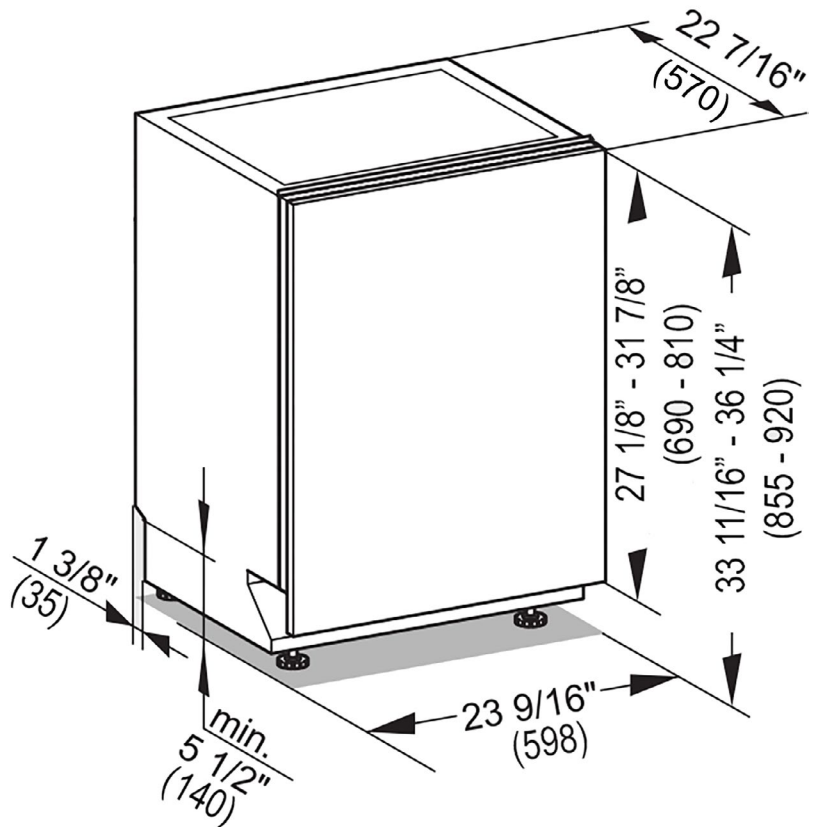

CUTOUT DIMENSIONS

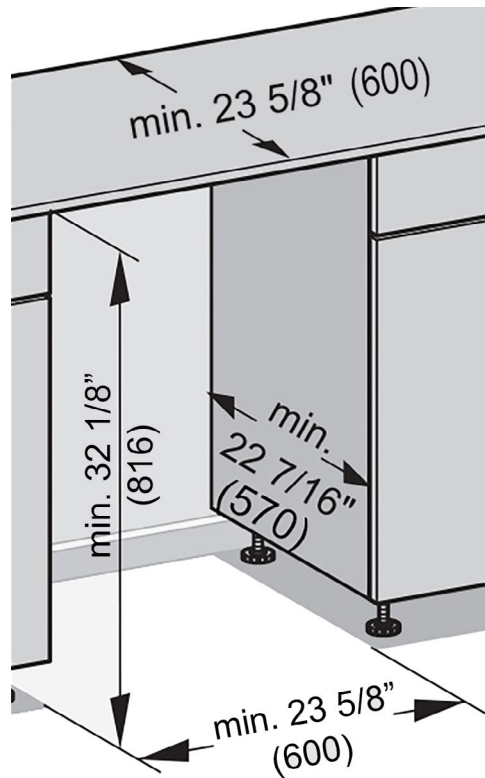

CUSTOM PANEL

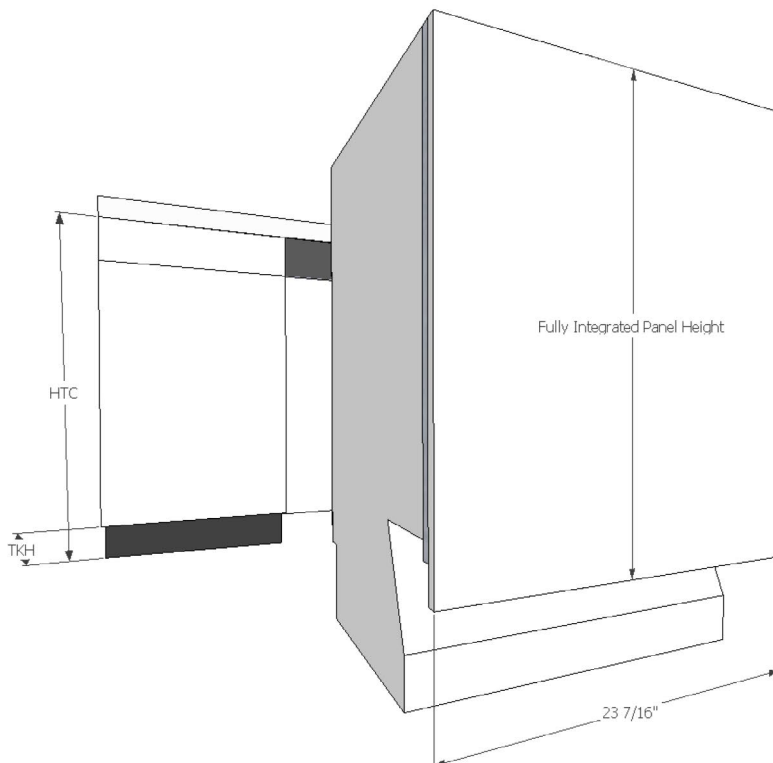

Width: 23 7/16" (598 mm) in all cases
Thickness: 3/4" (19 mm) in all cases
Height: Determined using the following calculation:
Panel Height = HTC – TKH

HTC = Height to the underside of countertop
TKH = Toe kick height

Note: Control panel is along the top edge of the unit. It is not visible when the unit is closed. A handle **MUST** be located on the front panel in order to open the unit.

Maximum panel height: 30 3/8" (772 mm)

Minimum panel height: 25 5/8" (650 mm)

Maximum panel weight: 26 lbs (12 kg)



SIGNATURE SERIES SHALLOW DEPTH
18" Depth Wine Reserve



Glass Door Model



Solid Door Model



ecofriendly
R600a Refrigerant



JOB	
AREA	
ITEM NO.	
MODEL NO.	

MODELS	DESCRIPTION
HH24WS-4-1R/L	Indoor Shallow Depth Wine Reserve Solid Stainless Steel Door
HH24WS-4-2R/L	Indoor Shallow Depth Wine Reserve Solid Panel Ready Door
HH24WS-4-3R/L	Indoor Shallow Depth Wine Reserve Stainless Steel Glass Door
HH24WS-4-4R/L	Indoor Shallow Depth Wine Reserve Panel Ready Glass Door
HH24WO-4-1R/L	Outdoor Shallow Depth Wine Reserve Solid Stainless Steel Door
HH24WO-4-2R/L	Outdoor Shallow Depth Wine Reserve Solid Panel Ready Door
HH24WO-4-3R/L	Outdoor Shallow Depth Wine Reserve Stainless Steel Glass Door
HH24WO-4-4R/L	Outdoor Shallow Depth Wine Reserve Panel Ready Glass Door
HH24WM-4-1R/L	Marine Shallow Depth Wine Reserve Solid Stainless Steel Door
HH24WM-4-2R/L	Marine Shallow Depth Wine Reserve Solid Panel Ready Door
HH24WM-4-3R/L	Marine Shallow Depth Wine Reserve Stainless Steel Glass Door
HH24WM-4-4R/L	Marine Shallow Depth Wine Reserve Panel Ready Glass Door

KEY PRODUCT FEATURES AND BENEFITS

- Industry's first 18" shallow depth for ultimate design flexibility in tight spaces
- Industry's largest selection of ADA-height compliant models for accessible and aging in place designs
- Superior construction provides ideal combination of energy efficient operation & powerful refrigeration performance ideal for food and beverages
- 1000 BTU/hr capacity delivers industry's most energy efficient cool down; indoors or outdoors
- Up to 70% faster cooling speeds than leading competitor
- All stainless steel interior and exterior provide superior durability and easy cleaning
- Wine shelves fully extend on vibration dampened, stainless steel ball-bearing glides; stainless steel wine shelves will not absorb odors over time
- Perlick Anti-Condensation System™ eliminates condensation from forming on the cabinet (Outdoor and Marine models only)
- Marine & Coastal Grade with Perlick Armor™ upgrades stainless steel, fasteners, and refrigeration system to the highest blend of corrosion resistance and food safety

Quick Features:

- Industry's best full 6 year warranty for owner ease of mind
- Available with stainless steel or panel ready door to match your design style
- Audible door alarm warns user if door is held open
- Selectable blue or white LED lighting
- R600a Natural Refrigerant offers maximum energy efficiency with zero ozone depletion potential
- Storage for up to 68 cans

Form No.Z2673
Rev 11.02.22



SIGNATURE SERIES SHALLOW DEPTH

18" Depth Wine Reserve

MODEL NUMBERS		HH24WS	HH24WO	HH24WM
MODEL DESCRIPTION		18" Indoor Wine Reserve	18" Outdoor Wine Reserve	18" Marine/Coastal Wine Reserve
ATTRIBUTES				
Perlick Anti-Condensation System		NO	YES	YES
Perlick Armor™		NO	NO	YES
OVERALL DIMENSIONS	Width - in. (mm)	23-7/8" (606 mm)	23-7/8" (606 mm)	23-7/8" (606 mm)
	Depth - in. (mm)	18" (457 mm)	18" (457 mm)	18" (457 mm)
	Height - in. (mm)	32" (813 mm)	32" (813 mm)	32" (813 mm)
STANDARD OPENING DIMENSIONS	Width - in. (mm)	24" (610 mm)	24" (610 mm)	24" (610 mm)
	Depth - in. (mm)	18" (457 mm)	18" (457 mm)	18" (457 mm)
	Height - in. (mm)	32-1/4" (819 mm)	32-1/4" (819 mm)	32-1/4" (819 mm)
INTERNAL VOLUME Net. Cu. Ft.		3.1 cu. ft.	3.1 cu. ft.	3.1 cu. ft.
SHIPPING WEIGHT Lbs. (kg.)		185 lbs (83.91 kg)	185 lbs (83.91 kg)	185 lbs (83.91 kg)
ELECTRICAL SPECIFICATIONS	Electrical Supply	115 VAC/60 Hz/1 Ph	115 VAC/60 Hz/1 Ph	115 VAC/60 Hz/1 Ph
	Running Load Amps	1,9 amps	1,9 amps	1,9 amps
	Electrical Connection	Cord connected	Cord connected	Cord connected
	Cord Plug Type	NEMA 3 Prong 5-15P	NEMA 3 Prong 5-15P	NEMA 3 Prong 5-15P
	Cord Length	6'	6'	6'
	Defrost Initiation	Automatic	Automatic	Automatic
	Defrost Type	Off cycle	Off cycle	Off cycle
	Thermostat	Digital	Digital	Digital
	Lighting Type	LED	LED	LED
REFRIGERATION SPECIFICATIONS	Refrigerant	R600a (62g)	R600a (62g)	R600a (62g)
	Expansion Device	Capillary Tube	Capillary Tube	Capillary Tube
	Temperature Settings F°(C°)	45° (7.2°) - 65° (18.3°) Factory Set Point 55° (12.7°)	45° (7.2°) - 65° (18.3°) Factory Set Point 55° (12.7°)	45° (7.2°) - 65° (18.3°) Factory Set Point 55° (12.7°)
	Heat Rejection (at 75°F)	350 BTU/hr	350 BTU/hr	350 BTU/hr
	Pull Down Capacity	1000 BTU/hr	1000 BTU/hr	1000 BTU/hr
	Front Vented	Yes	Yes	Yes
PLUMBING		None Required	None Required	None Required

Installation Notes: To achieve 24" install depth, place electrical connection adjacent to the installation cavity.

ACCESSORIES

MODEL NOS.	DESCRIPTION
(L)	Factory Installed Lock
67992-L/R	Stacking Kit for HH24 models
67115-24	Wood Faces for Wine Shelves (7/pk)
67360	6" Toe Kick and Riser

Perlick accessories are available for purchase through an authorized Perlick dealer. For a full list of accessories and to find a dealer near you, visit perlick.com.



WARNING: California Prop 65 Notice

These products may expose you to chemicals including Chromium, which are known to the state of California to cause cancer and birth defects or other reproductive harm. For more information on whether a product in this list contains these chemicals, please refer to the specific product page at perlick.com. Or to find out more about **Prop 65**, go to P65Warnings.ca.gov.



SIGNATURE SERIES SHALLOW DEPTH
18" Depth Wine Reserve

	CUSTOMER MODEL NUMBER	REGULATORY MODEL NUMBER	Hinge Side	Lock
INDOOR	HH24WS-4-1L	HH24WS4F-00-SLF0W	Left	No
	HH24WS-4-1R	HH24WS4F-00-SRF0W	Right	No
	HH24WS-4-2L	HH24WS4F-00-PL00W	Left	No
	HH24WS-4-2R	HH24WS4F-00-PR00W	Right	No
	HH24WS-4-3L	HH24WS4F-00-TLF0W	Left	No
	HH24WS-4-3R	HH24WS4F-00-TRF0W	Right	No
	HH24WS-4-4L	HH24WS4F-00-RL00W	Left	No
	HH24WS-4-4R	HH24WS4F-00-RR00W	Right	No
	HH24WS-4-1LL	HH24WS4F-00-SLFLW	Left	Yes
	HH24WS-4-1RL	HH24WS4F-00-SRFLW	Right	Yes
	HH24WS-4-2LL	HH24WS4F-00-PL0LW	Left	Yes
	HH24WS-4-2RL	HH24WS4F-00-PR0LW	Right	Yes
	HH24WS-4-3LL	HH24WS4F-00-TLFLW	Left	Yes
	HH24WS-4-3RL	HH24WS4F-00-TRFLW	Right	Yes
	HH24WS-4-4LL	HH24WS4F-00-RL0LW	Left	Yes
	HH24WS-4-4RL	HH24WS4F-00-RR0LW	Right	Yes
OUTDOOR	HH24WO-4-1L	HH24WO4F-00-SLF0W	Left	No
	HH24WO-4-1R	HH24WO4F-00-SRF0W	Right	No
	HH24WO-4-2L	HH24WO4F-00-PL00W	Left	No
	HH24WO-4-2R	HH24WO4F-00-PR00W	Right	No
	HH24WO-4-3L	HH24WO4F-00-TLF0W	Left	No
	HH24WO-4-3R	HH24WO4F-00-TRF0W	Right	No
	HH24WO-4-4L	HH24WO4F-00-RL00W	Left	No
	HH24WO-4-4R	HH24WO4F-00-RR00W	Right	No
	HH24WO-4-1LL	HH24WO4F-00-SLFLW	Left	Yes
	HH24WO-4-1RL	HH24WO4F-00-SRFLW	Right	Yes
	HH24WO-4-2LL	HH24WO4F-00-PL0LW	Left	Yes
	HH24WO-4-2RL	HH24WO4F-00-PR0LW	Right	Yes
	HH24WO-4-3LL	HH24WO4F-00-TLFLW	Left	Yes
	HH24WO-4-3RL	HH24WO4F-00-TRFLW	Right	Yes
	HH24WO-4-4LL	HH24WO4F-00-RL0LW	Left	Yes
	HH24WO-4-4RL	HH24WO4F-00-RR0LW	Right	Yes
MARINE & COASTAL	HH24WM-4-1L	HH24WM4F-00-MLF0W	Left	No
	HH24WM-4-1R	HH24WM4F-00-MRF0W	Right	No
	HH24WM-4-2L	HH24WM4F-00-PL00W	Left	No
	HH24WM-4-2R	HH24WM4F-00-PR00W	Right	No
	HH24WM-4-3L	HH24WM4F-00-NLF0W	Left	No
	HH24WM-4-3R	HH24WM4F-00-NRF0W	Right	No
	HH24WM-4-4L	HH24WM4F-00-RL00W	Left	No
	HH24WM-4-4R	HH24WM4F-00-RR00W	Right	No
	HH24WM-4-1LL	HH24WM4F-00-MLFLW	Left	Yes
	HH24WM-4-1RL	HH24WM4F-00-MRFLW	Right	Yes
	HH24WM-4-2LL	HH24WM4F-00-PL0LW	Left	Yes
	HH24WM-4-2RL	HH24WM4F-00-PR0LW	Right	Yes
	HH24WM-4-3LL	HH24WM4F-00-NLFLW	Left	Yes
	HH24WM-4-3RL	HH24WM4F-00-NRFLW	Right	Yes
	HH24WM-4-4LL	HH24WM4F-00-RL0LW	Left	Yes
	HH24WM-4-4RL	HH24WM4F-00-RR0LW	Right	Yes

Form No.Z2673
Rev 11.02.22



SIGNATURE SERIES SHALLOW DEPTH
18" Depth Wine Reserve

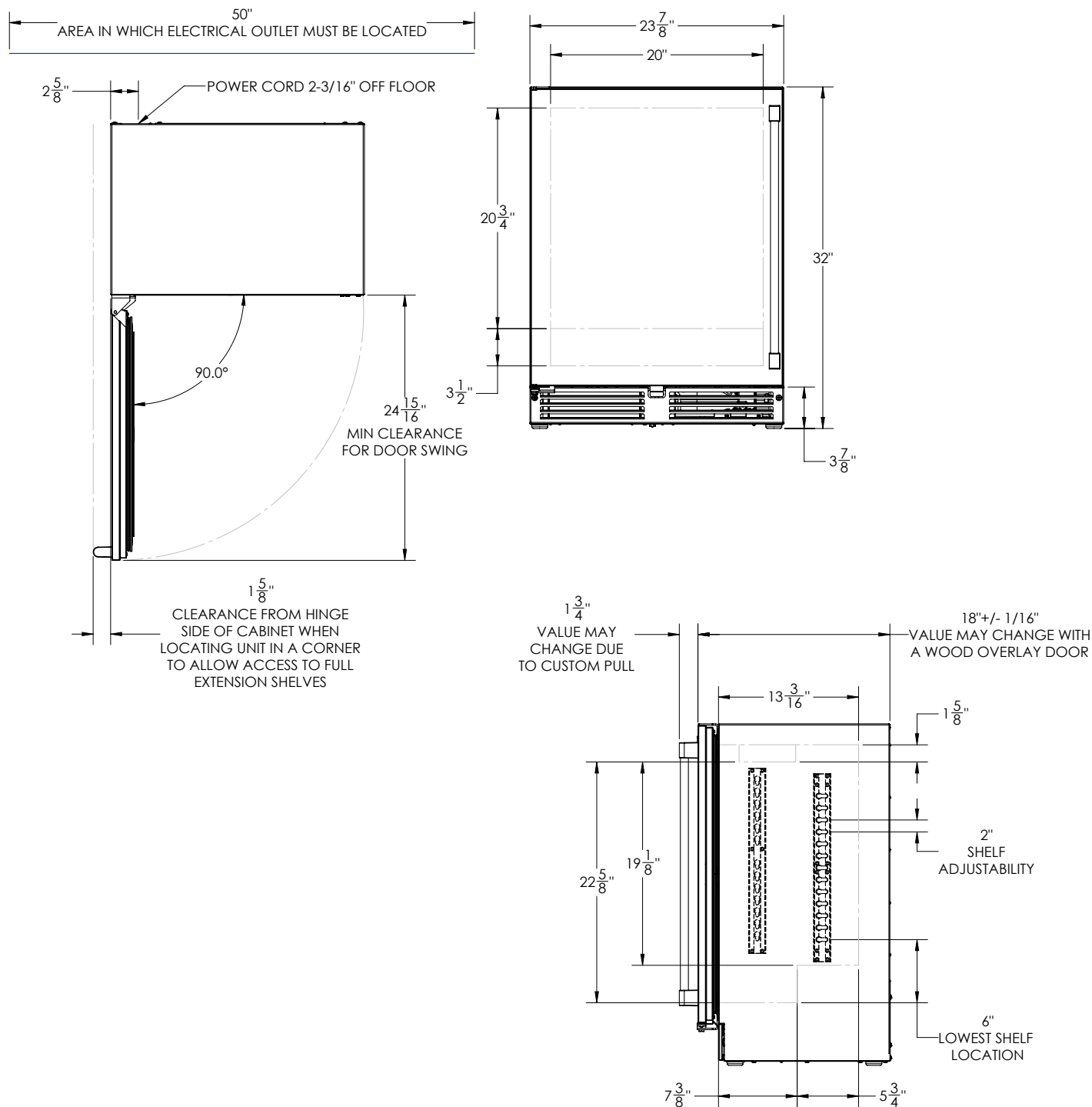

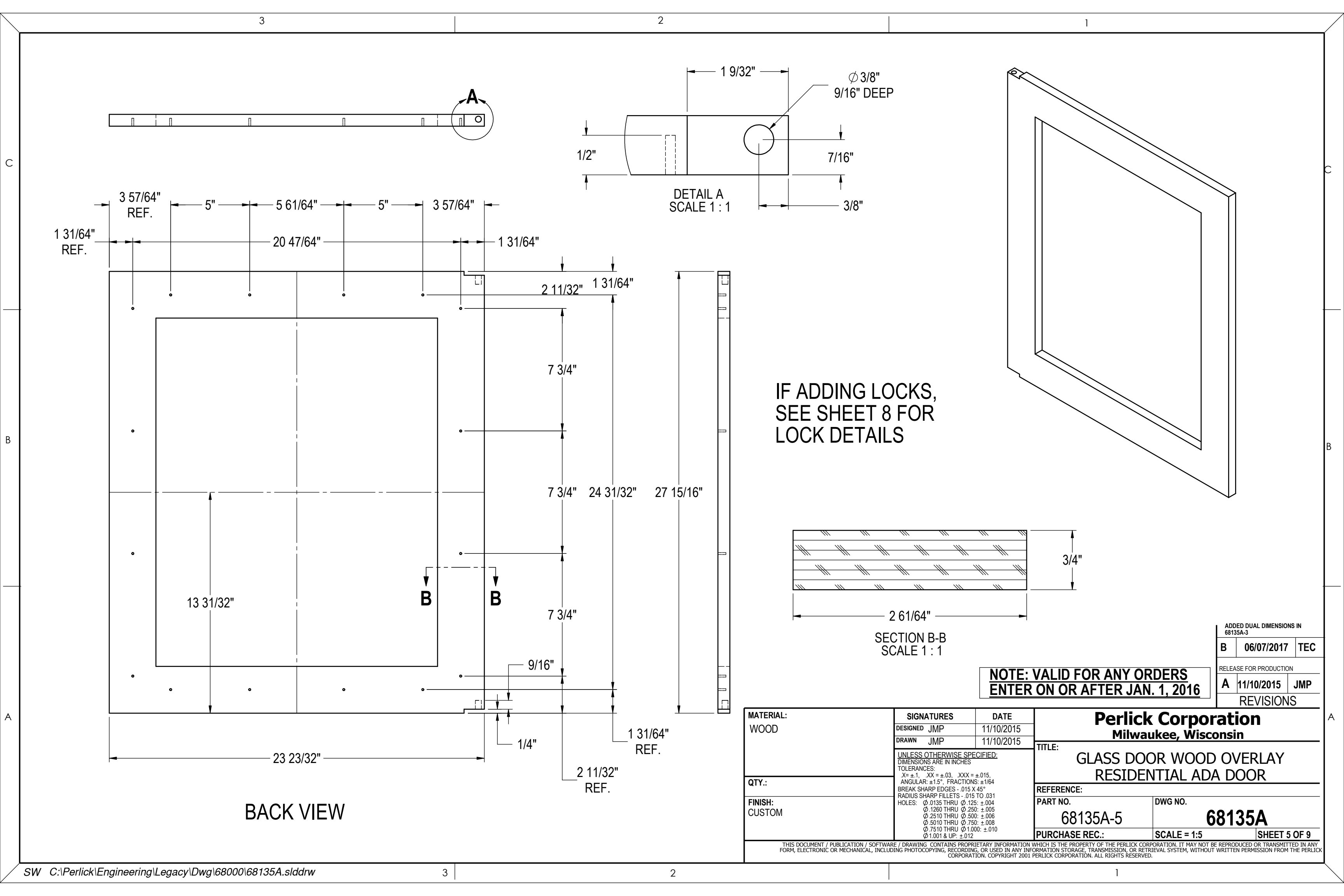

DEU2450R



FEATURES

- Fully customizable exterior—accepts custom panels for an integrated look within cabinetry or stainless-steel accessory panels and handles to coordinate with other Sub-Zero, Wolf, and Cove appliances
- Seamlessly integrating anywhere, undercounter refrigeration adds comfort to your master suite, creates a corner for libations in the study, provides subtle storage for delicate cosmetics—the options are endless
- Flexible storage options with one stationary and two adjustable shelves
- Two on-door shelves easily accommodate a wide variety of condiments and beverages, with ample room for larger two-liter bottles
- Intuitive, on-door touch control panel offers ergonomic, convenient access to settings
- Nano coating lines the perimeter of each glass shelf to create a hydrophobic barrier that helps contain spills
- Clear storage drawer provides quick access to essential items
- Offers precise temperature control within one degree of setpoint, preserving dairy, produce, craft beer, and other perishables at their optimal temperature
- Soft-on LED lighting fully illuminates the interior when the door is open
- Control your appliance from wherever you are using our convenient Owner's App—adjust temperatures, be notified of a door left ajar, or receive remote service diagnostics

ACCESSORIES

- Custom Panel Lock Kit
- Dual Install Kit - Handle-to-Drawer
- Dual Install Kit - Handle-to-Handle
- Pro Handle
- Tubular Handle
- Stainless Steel Solid Door Panels
- Stainless Steel Dual Kickplates

Accessories are available through an authorized dealer.
For local dealer information, visit subzero-wolf.com/locator.



HANDLE ACCESSORIES

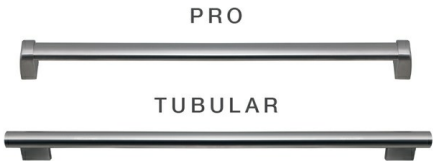

PRODUCT DETAILS

REFRIGERATOR

- One stationary and two adjustable shelves
- Two on-door shelves
- Clear storage drawer

PRODUCT SPECIFICATIONS

Model	DEU2450R
Dimensions	24"W x 34 1/2"H x 23 1/8"D
Refrigerator Capacity	5.4 cu. ft.
Weight	133 lbs
Electrical Supply	115 VAC, 60 Hz
Electrical Service	15 amp dedicated circuit
Receptacle	3-prong grounding-type

ELECTRICAL

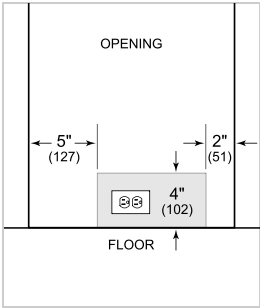

NOTE: The electrical outlet must be positioned with the grounding prong to the right of the thinner blades.

PANEL SPECIFICATIONS For complete panels specifications including width/height, weight requirements and thickness requirements visit subzero-wolf.com/reveal.

NOTE: Dimensions in parenthesis are in millimeters unless otherwise specified

INTERIOR VIEW

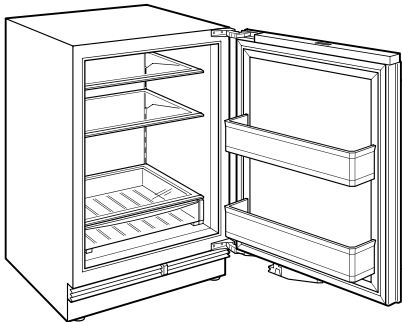

This illustration is intended for interior reference only and may not represent the exterior of the model being specified.

DIMENSIONS

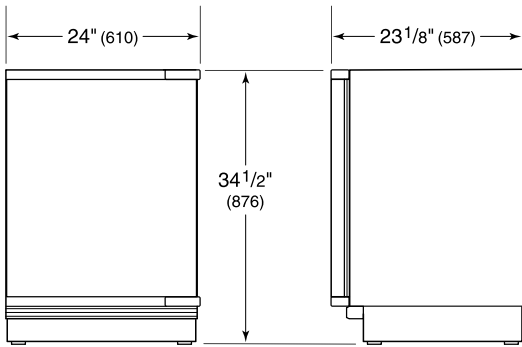

HEIGHT DIMENSIONS $\pm 1/2"$ (13)

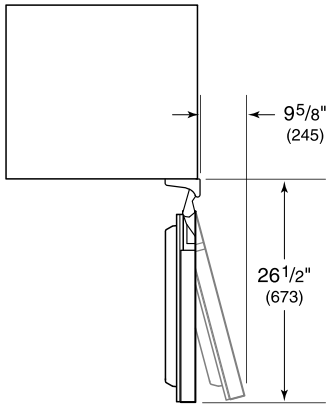

STANDARD INSTALLATION

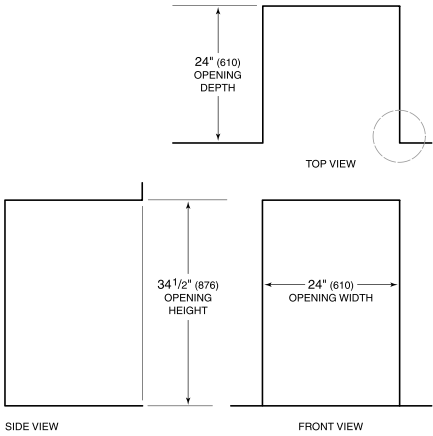

NOTE: 3 1/2" (89) finished returns will be visible and should be finished to match cabinetry.

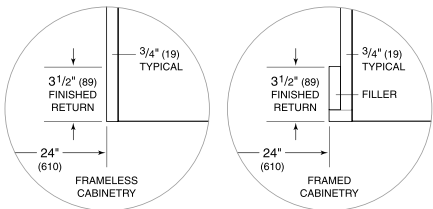

Panel Specifications

Single Model: DEU2450R

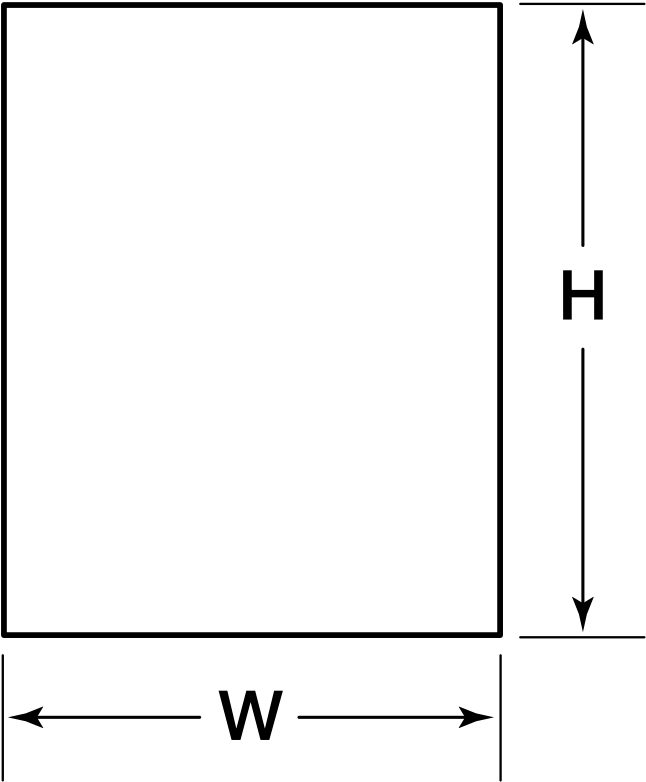

PANEL	WIDTH	HEIGHT	MIN THICKNESS	MAX WEIGHT
Door	23 ³ / ₄ "	30 ³ / ₈ "	⁵ / ₈ "	22 lbs

Panel Planning Notes

Single Model: DEU2450R

The thickness of the custom panel can vary. A 5/8" (16) minimum to 3/4" (19) maximum thick panel is required.

The depth of each designer model is 23 1/8" (587). Allow for panel thickness when planning the finished opening depth.

Finish all sides of custom panels. They will be visible when the door is open.

Stainless steel tubular and pro handles are available through an authorized Sub-Zero dealer.

Minimum Panel Thickness

5/8"

Standard Handle Lengths (Optional)

HANDLE	TUBULAR	PRO
DEU2450R Door	24 3/16"	22 1/2"

Toe Kick Clearance

