

NOTES

Drawing may not be scaled.
The numerical dimensions represent correct measurements.
All dimensions are given from finished floor and finished wall unless otherwise noted.
All design ideas, drawings, and plans represented here are owned by the property of **WESTHAVEN CONSTRUCTION SERVICES INC.**
All rights reserved.
Above suggested electrical and plumbing locations, must be verified in field.
All these ideas are based on the existing conditions in the apartment and to be verified after demolition.

DATE

CLIENT APPROVED / ACCEPT.

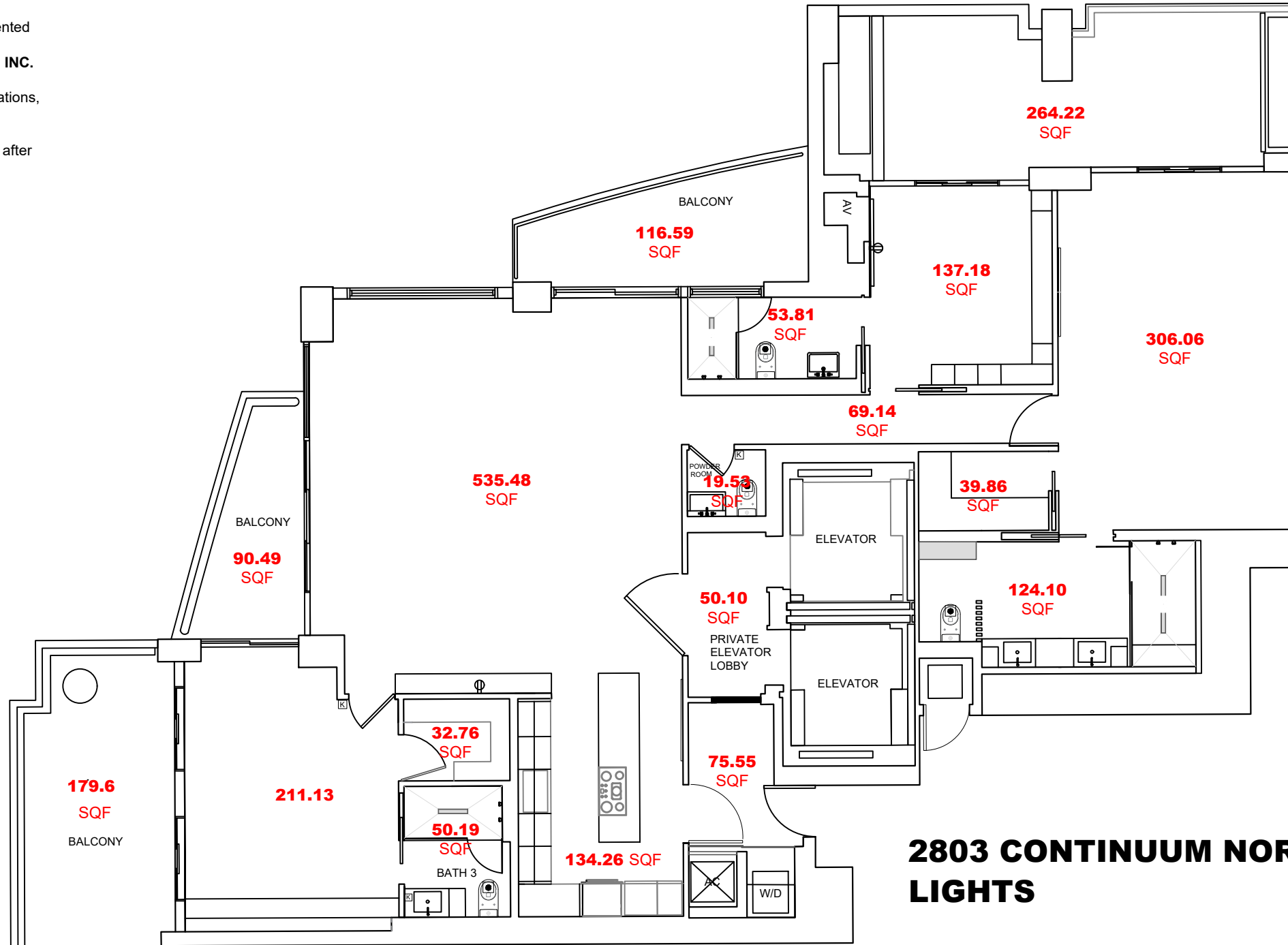

2803 CONTINUUM NORTH LIGHTS

1/8" = 1'-0"



WESTHAVEN
CONSTRUCTION SERVICES, INC.

CLIENT
M. ADDRESS

PROJECT
2803
PROJECT NAME
CONTINUUM NORTH

DRAWN BY
Abel Q.
DESIGN BY
Joel A.
DESCRIPTION
AREAS

A-01