

**YUKON OFFICES BUILDING SUITE 403 A  
EXISTING REFLECTED CEILING PLAN**  
SCALE: 1/4" = 1'-0"

**NOTE:**  
EXISTING ENTIRE CEILING IS A R/A PLENUM AND THAT WAS CONSTRUCTED AND ONLY CONTAIN NON-COMBUSTIBLE MATERIAL WITH MAXIMUM RATINGS OF 25 FOR FLAME SPREAD AND 50 FOR SMOKE DEVELOPED INDEX.

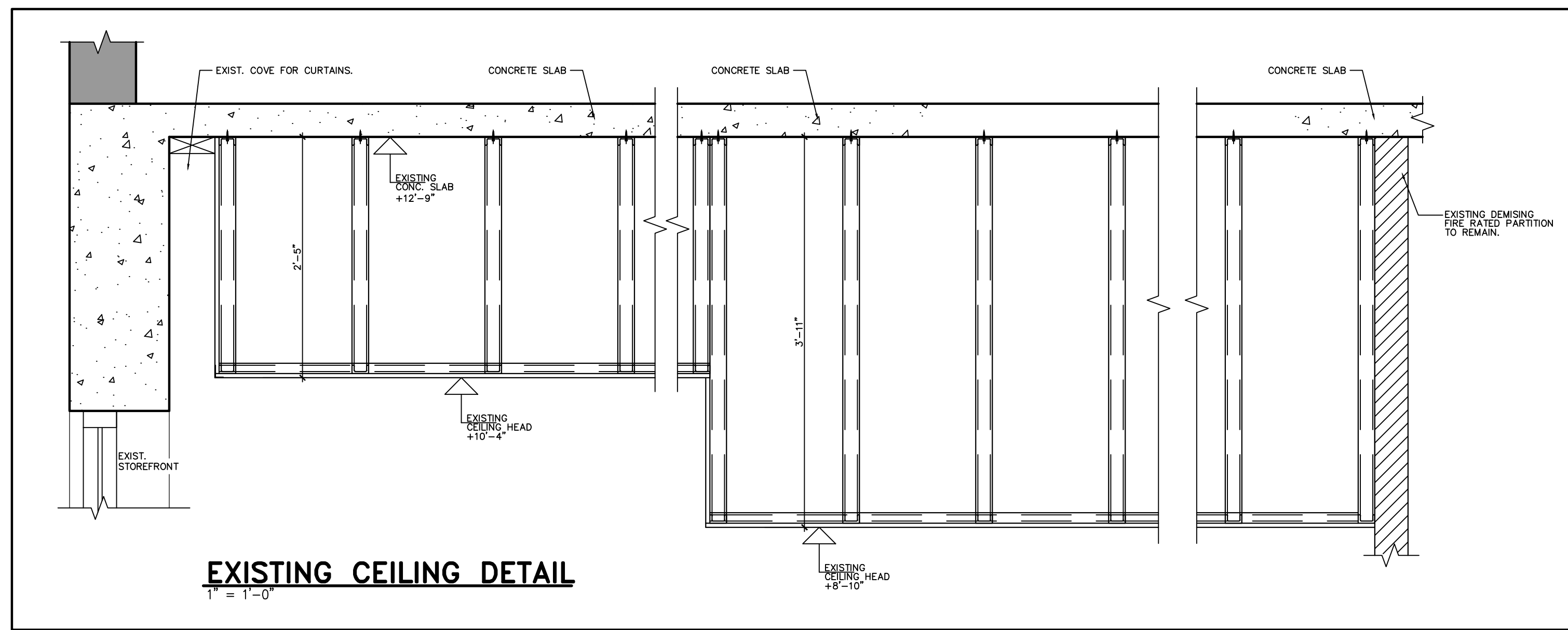
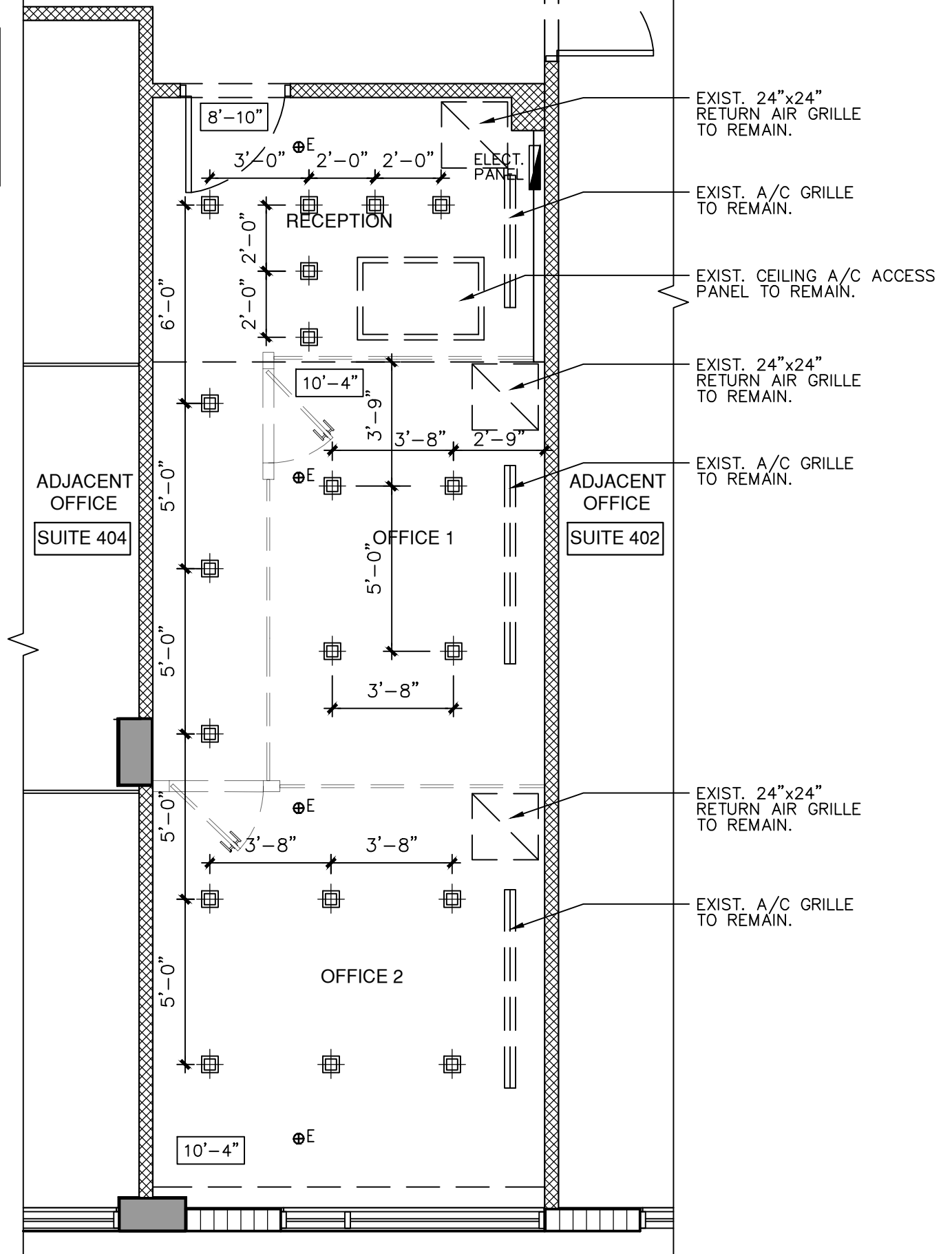

**EXISTING CEILING DETAIL**  
1" = 1'-0"

**Fine Line Engineers Inc.**  
Electrical, Mechanical, Plumbing  
Fire Protection, Construction Administration  
7600 W. 20TH AVE Suite #110 Hialeah, FL 33016  
Voice: 786-953-4901 - Fax: 786-953-4907  
E-mail: cadinfo@flengineers.com

GEORGE FREIJO, P.E.  
REGISTERED ENGINEER NO. 32578  
STATE OF FLORIDA CA# 29796

DATE \_\_\_\_\_

**WESTHAVEN**  
CONSTRUCTION SERVICES, INC.

**Westhaven Construction Services, Inc.**  
8254 NW South River Drive, Medley FL 33166  
LIC No CBC1259615  
305-556-4416 Cell 305-979-8624  
archgarcia@gmail.com

**Fine Line Engineers Inc.**  
Electrical, Mechanical, Plumbing, Fire Protection  
Construction Administration  
7600 W. 20TH AVE SUITE 110, HIALEAH, FLORIDA, 33016  
E-mail: info@flengineers.com

**INTERIOR RENOVATION FOR:  
YUKON OFFICES BUILDING  
YANTRA 119 LLC,  
SUITE No 403 A  
119 Washington Avenue, Miami Beach, FL 33139**

JOB No. 2305 ROD  
STARTED: 07/10/23  
COMPLETED: 08/10/23

REVISION	
No.	DESCRIPTION DATE

Copyright notice: These drawings, designs and ideas are the property of Westhaven Construction Services, Inc. and are protected under the copyright laws of Florida. No part thereof shall be copied, or used in connection with any work other than for the specific project for which they have been prepared without written consent of Westhaven Construction Services, Inc.