



WESTHAVEN
CONSTRUCTION SERVICES, INC.

8254 South River Dr
Medley, FL 33166
Ph. 305 556 1416
www.westhavencn.com

**PROGRESS DRAWING
FOR APPROVAL**



© 2023 WHCN

CONTACT DESIGN TEAM

BASE VERSION

SUBJECT TO REVISIONS

ISSUE
01/ 2/ 2024
RE - ISSUE
03/12/2024

DESIGN BY
J. Alonso
DRAWN BY
A. Quintero
OWNER
OO
PAGE NAME
COVER PAGE

DESIGN CONCEPT

**ALL MEASUREMENTS
MUST BE
VERIFIED IN FIELD**

DISCARD ALL DRAWINGS THAT
WERE MADE ON THIS ITEM PRIOR
TO THE DATE BELOW:

03/12/2024

This drawing is not intended to be used
for contract pricing or fabrication
purposes.
All content is subject to change

COVER PAGE

KITCHEN

DROP CEILING (PAGE 4)

CABINET GARAGE DOOR

FINISH L&T
SATIN BLACKWOOD
Item No: KO22

STONE DEKTON[®]
designed by COSENTINO
TAGA STONIKA
Item No:

STONE DEKTON[®]
designed by COSENTINO
NOKA
Item No:



3603 ICON

KITCHEN

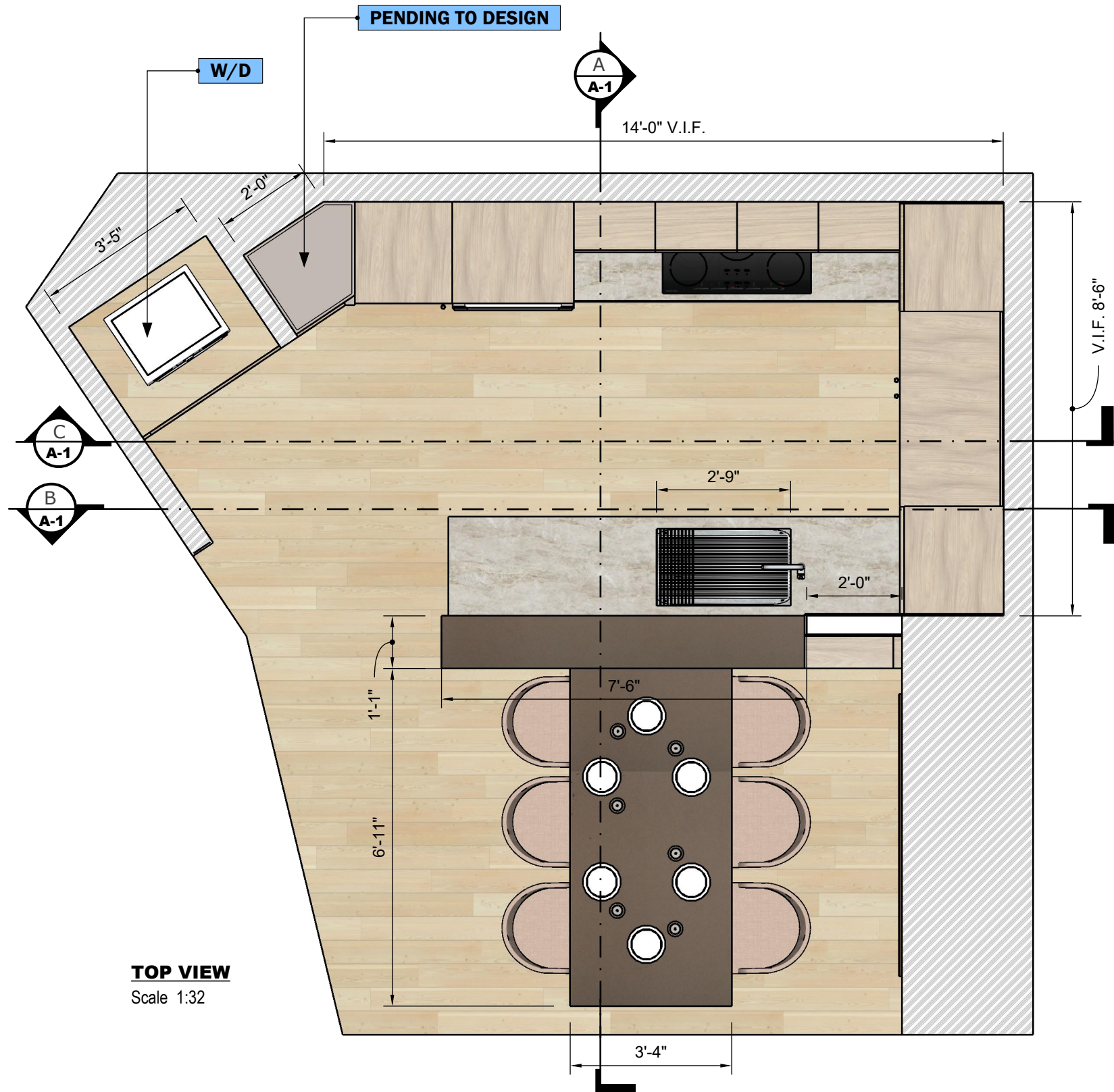

TOP VIEW
Scale 1:32

This plan presents preliminary proposals for materials, measurements, and design. Please note that these proposals are subject to possible changes.

- Materials:** Proposed materials are subject to evaluation and final selection.
- Measurements:** Indicated measurements are approximate and may be adjusted during the design and construction process.
- Design:** The presented design is an initial proposal and may undergo modifications.
- Approvals and revisions:** Any changes to materials, measurements, or design require appropriate approval.

This plan does not represent the final version of the project, and adjustments will be made to ensure quality and goal fulfillment.

NOTE
Drawings may not be scaled.
The numerical dimensions represent correct measurements. (If not indicated, the precision of the dimensions by default is to 1")
All design ideas, drawings and plans represented here are owned by the property of WESTHAVEN CONSTRUCTION SERVICES, INC. All rights reserved. Above suggested electrical and plumbing locations, must be verified in field.



ISSUE	01/ 2/ 2024
RE - ISSUE	03/12/2024

3603 ICON	OWNER	PAGE NAME
0000 Fl, 33000	OO	TOP VIEW
DESIGN BY	DRAWN BY	
J. Alonso	A. Quintero	

DESIGN CONCEPT

**ALL MEASUREMENTS
MUST BE
VERIFIED IN FIELD**

DISCARD ALL DRAWINGS THAT
WERE MADE ON THIS ITEM PRIOR
TO THE DATE BELOW:

03/12/2024

This drawing is not intended to be used
for contract pricing or fabrication
purposes.
All content is subject to change

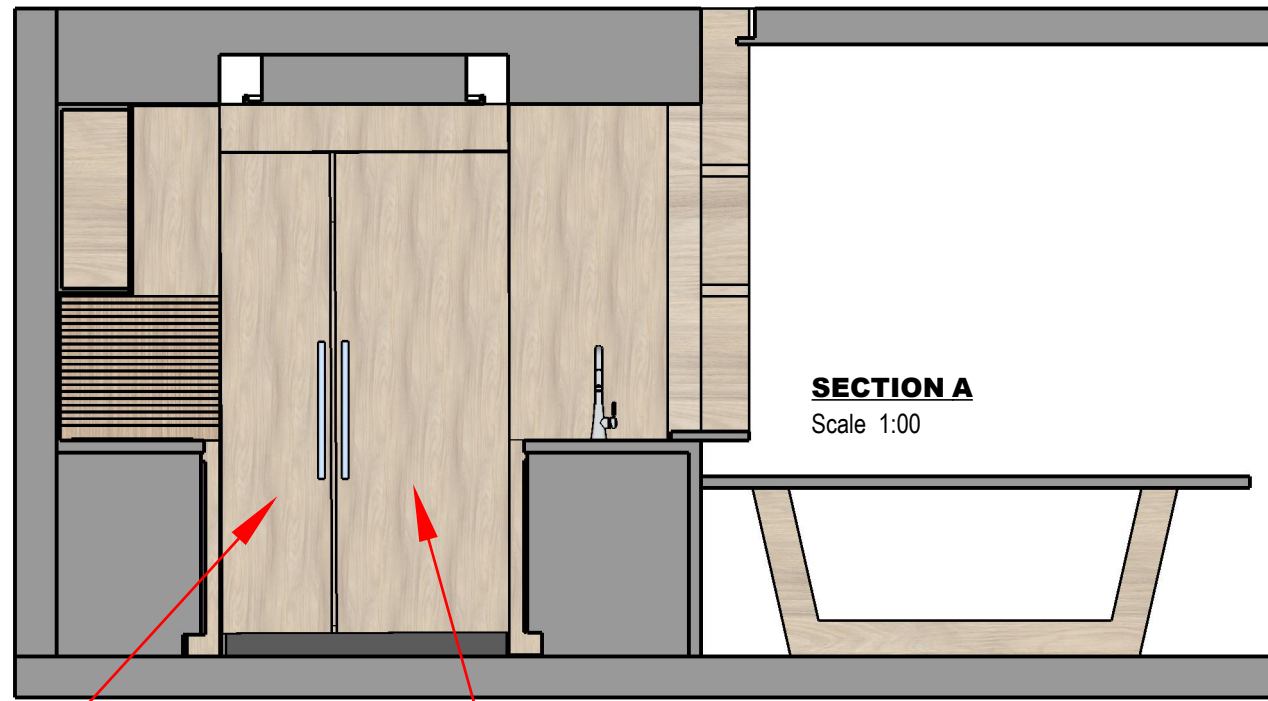

SECTION A
Scale 1:00

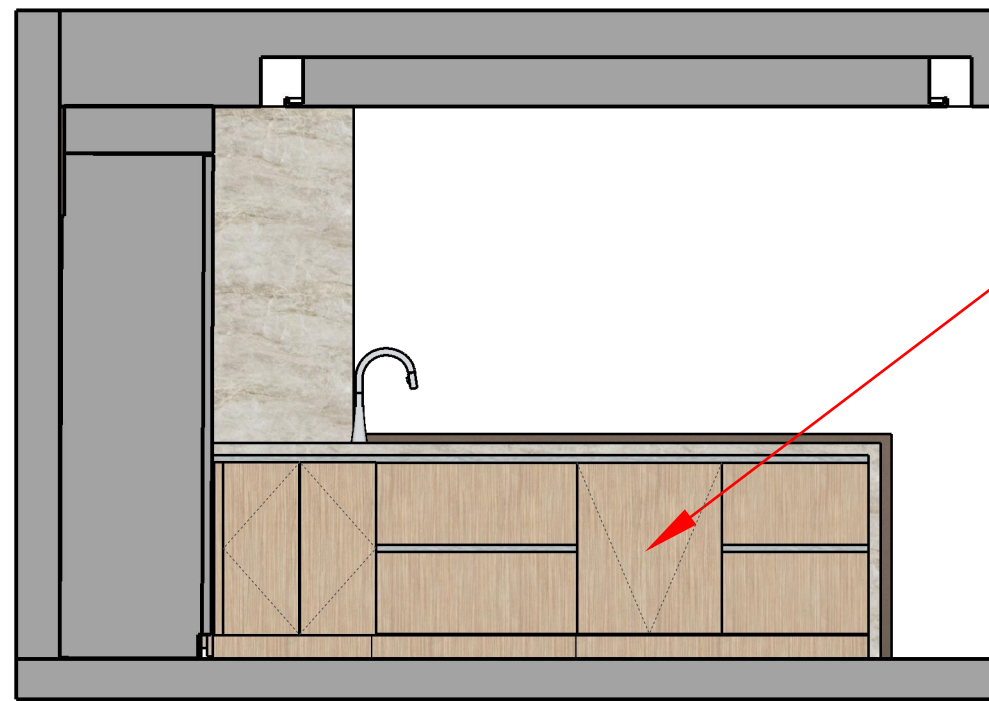

SECTION B
Scale 1:00



DISHWASHER
SERIE: DW24U211
Fisher & Paykel Dishwasher
Integrated Dishwasher, 24"

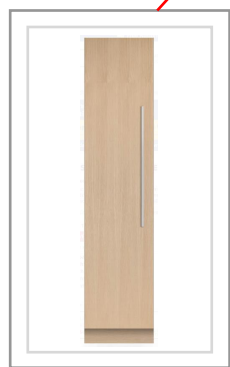

FREEZER
SERIE: RS1884FLJK1
Fisher & Paykel Refrigeration
Integrated Column Freezer, 18", Ice



REFRIGERATOR
SERIE: RS3084SRHK1
Fisher & Paykel Refrigeration
Integrated Column Refrigerator, 30", Water



ITEM NAME
SERIE: OM24NDB1
Fisher & Paykel Wall Oven
Convection Speed Oven 24"



TRIM KIT
SERIE: TK30NDB1
Fisher & Paykel - 30" Trim Kit - Black Glass



ITEM NAME
SERIE: OB30SDPTDX1
Fisher & Paykel Wall Oven
Oven, 30", 17 Function, Self-cleaning



WINE CABINET
SERIE: RS2484VL2K1
Fisher & Paykel Refrigeration
Integrated Column Wine Cabinet, 24"

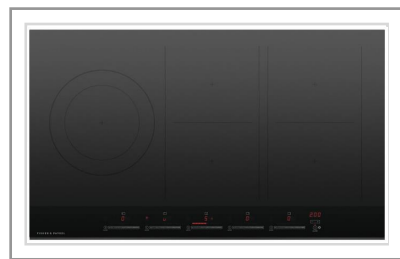

ITEM NAME
SERIE: CI365DTB4
Fisher & Paykel Cooktop Induction Cooktop, 36", 5
Zones with SmartZone

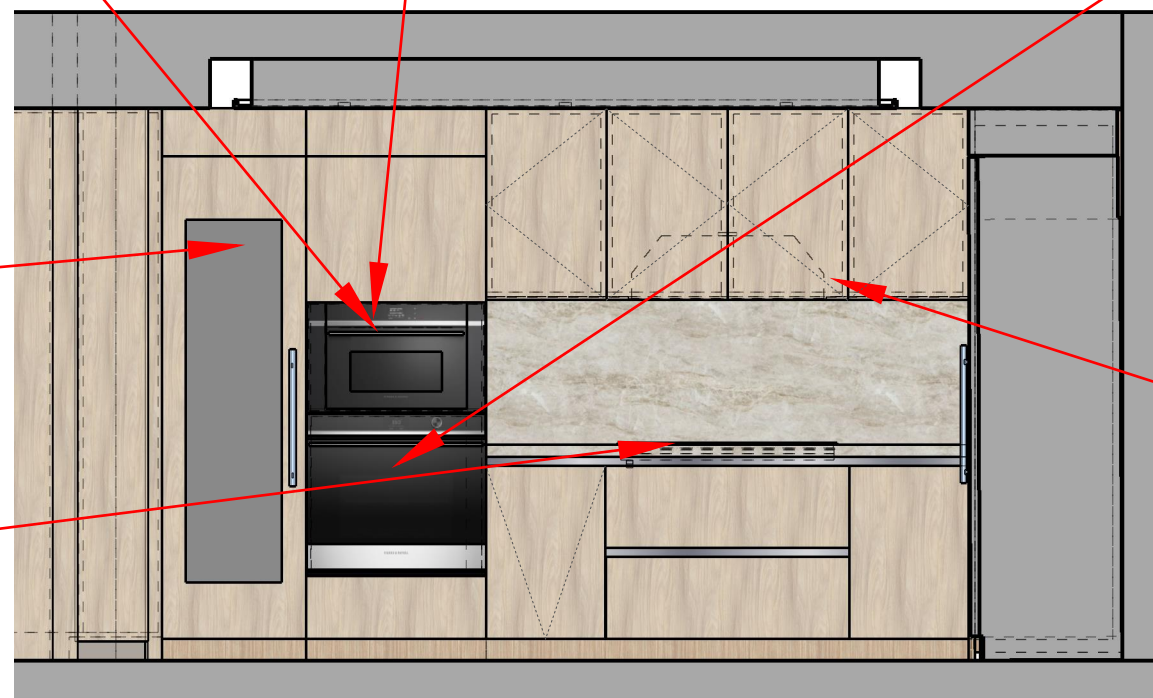

SECTION C
Scale 1:00

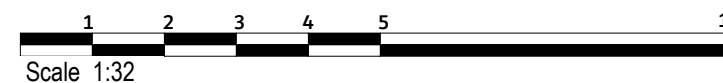

HOOD
SERIE: FIVAL34B5SS-R
Falmec Ventilation

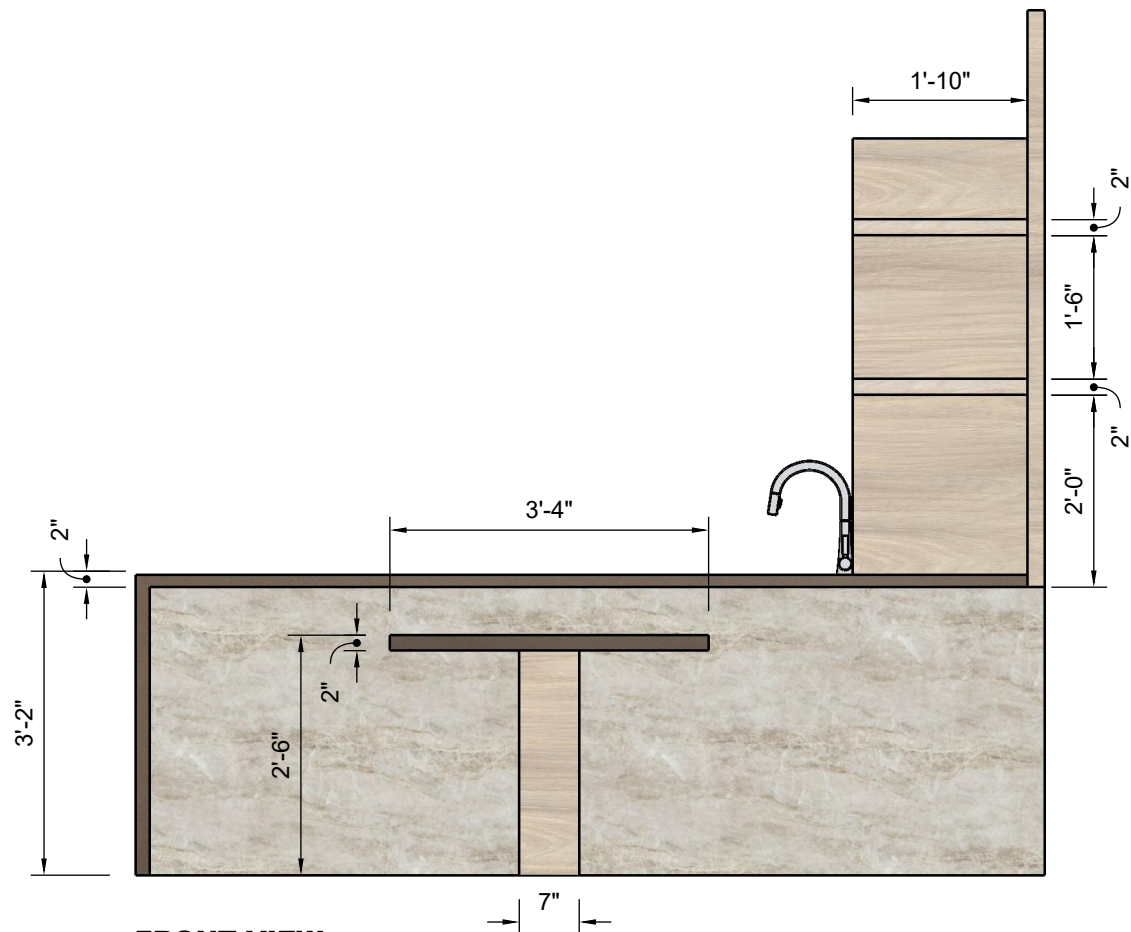

FRONT VIEW

Scale 1:24

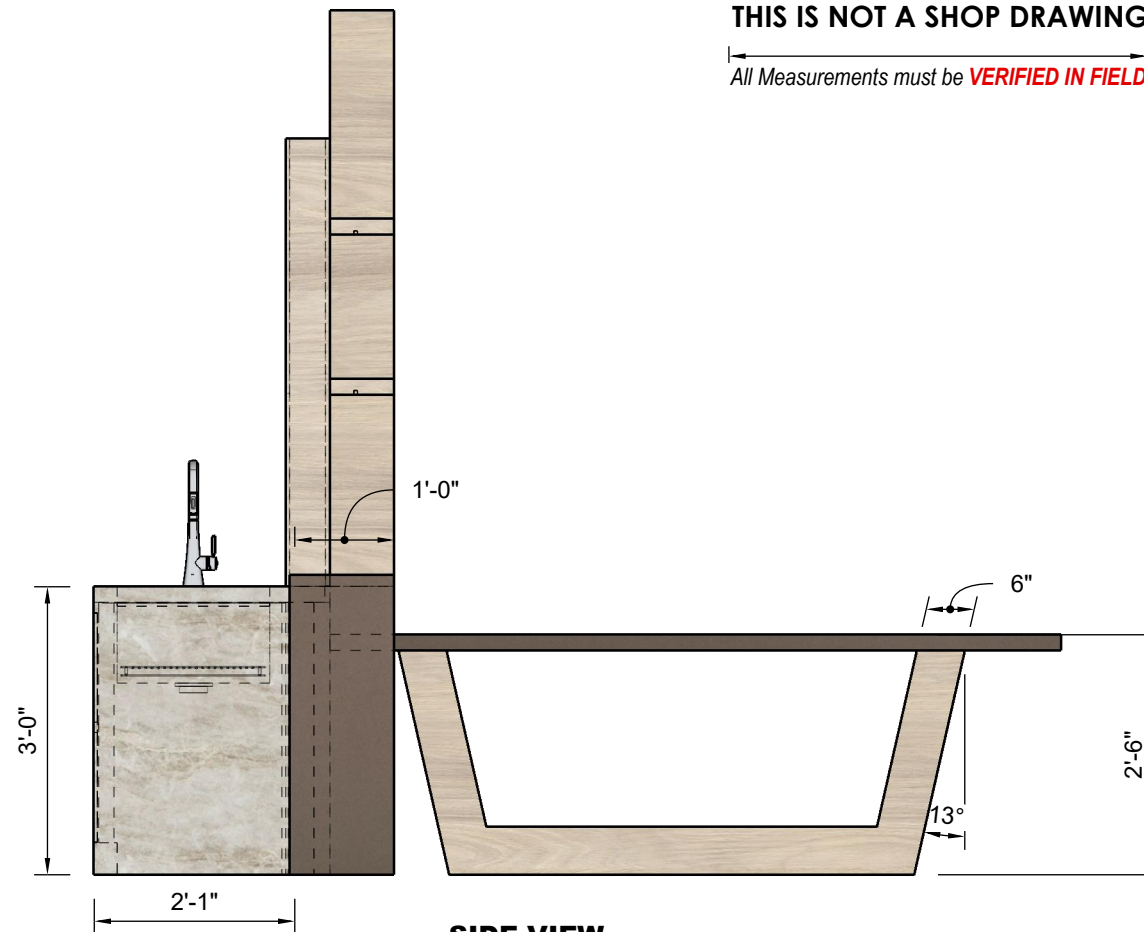

SIDE VIEW

1:24

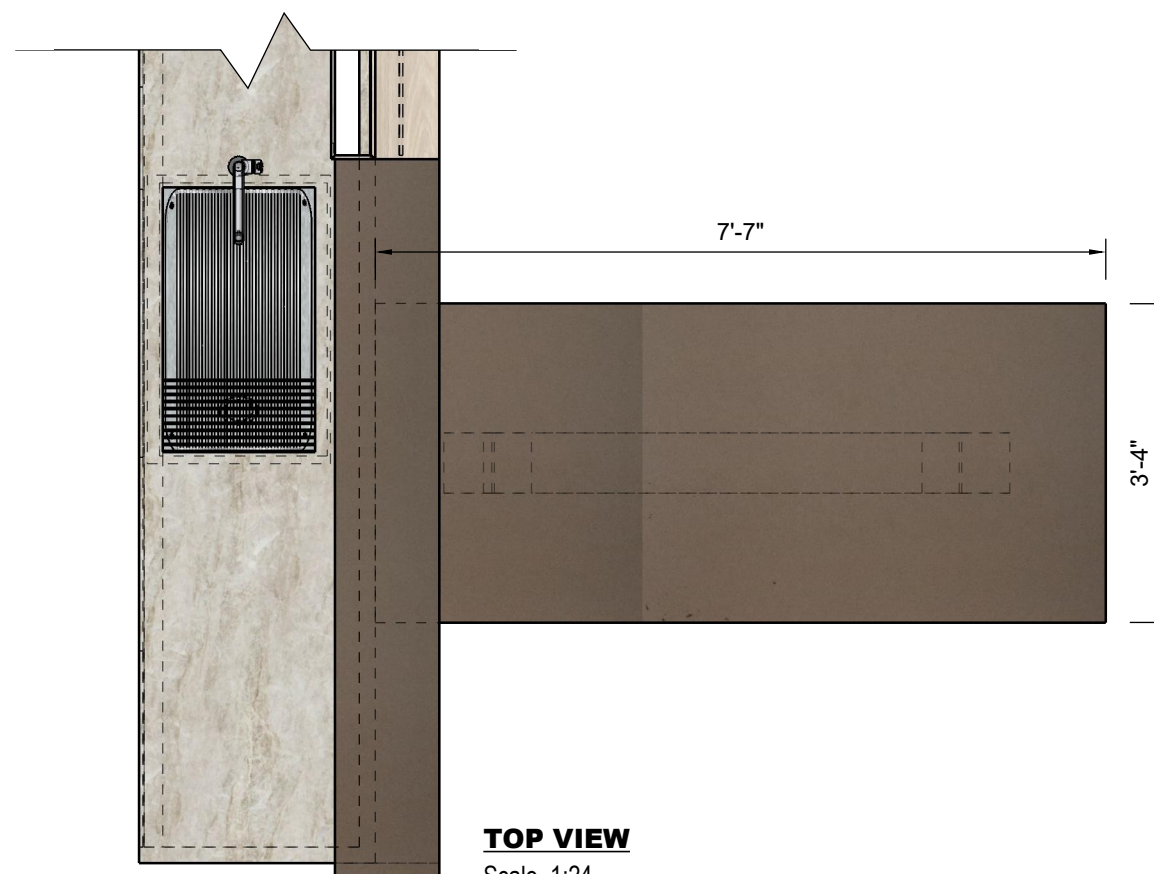

TOP VIEW

Scale 1:24

THIS IS NOT A SHOP DRAWING

All Measurements must be **VERIFIED IN FIELD**

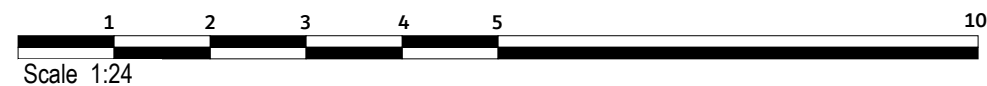

Scale 1:24

This plan presents preliminary proposals for materials, measurements, and design. Please note that these proposals are subject to possible changes.

Materials: Proposed materials are subject to evaluation and final selection.

Measurements: Indicated measurements are approximate and may be adjusted during the design and construction process.

Design: The presented design is an initial proposal and may undergo modifications.

Approvals and revisions: Any changes to materials, measurements, or design require appropriate approval.

This plan does not represent the final version of the project, and adjustments will be made to ensure quality and goal fulfillment.



WESTHAVEN
CONSTRUCTION SERVICES, INC.

8254 South River Dr
Medley, FL 33166
Ph. 305 556 1416
www.westhavencn.com

**PROGRESS DRAWING
FOR APPROVAL**



© 2023 WHCN

CONTACT DESIGN TEAM

BASE VERSION
SUBJECT TO REVISIONS

ISSUE 01/ 2/ 2024
RE - ISSUE 03/12/2024

3603 ICON
0000 FI, 33000
DESIGN BY J. Alonso
DRAWN BY A. Quintero
OWNER OO
PAGE NAME TABLE AND SHELVES

DESIGN CONCEPT

**ALL MEASUREMENTS
MUST BE
VERIFIED IN FIELD**

DISCARD ALL DRAWINGS THAT
WERE MADE ON THIS ITEM PRIOR
TO THE DATE BELOW:

03/12/2024

This drawing is not intended to be used
for contract pricing or fabrication
purposes.
All content is subject to change

A - 03

KITCHEN

R4-DS589TL-MW

4" Square Trim-less Die Cast Trim
Accessible light source from the bottom of the trim.
via twist and Lock ring

RECESSED LIGHTS

LED LINE

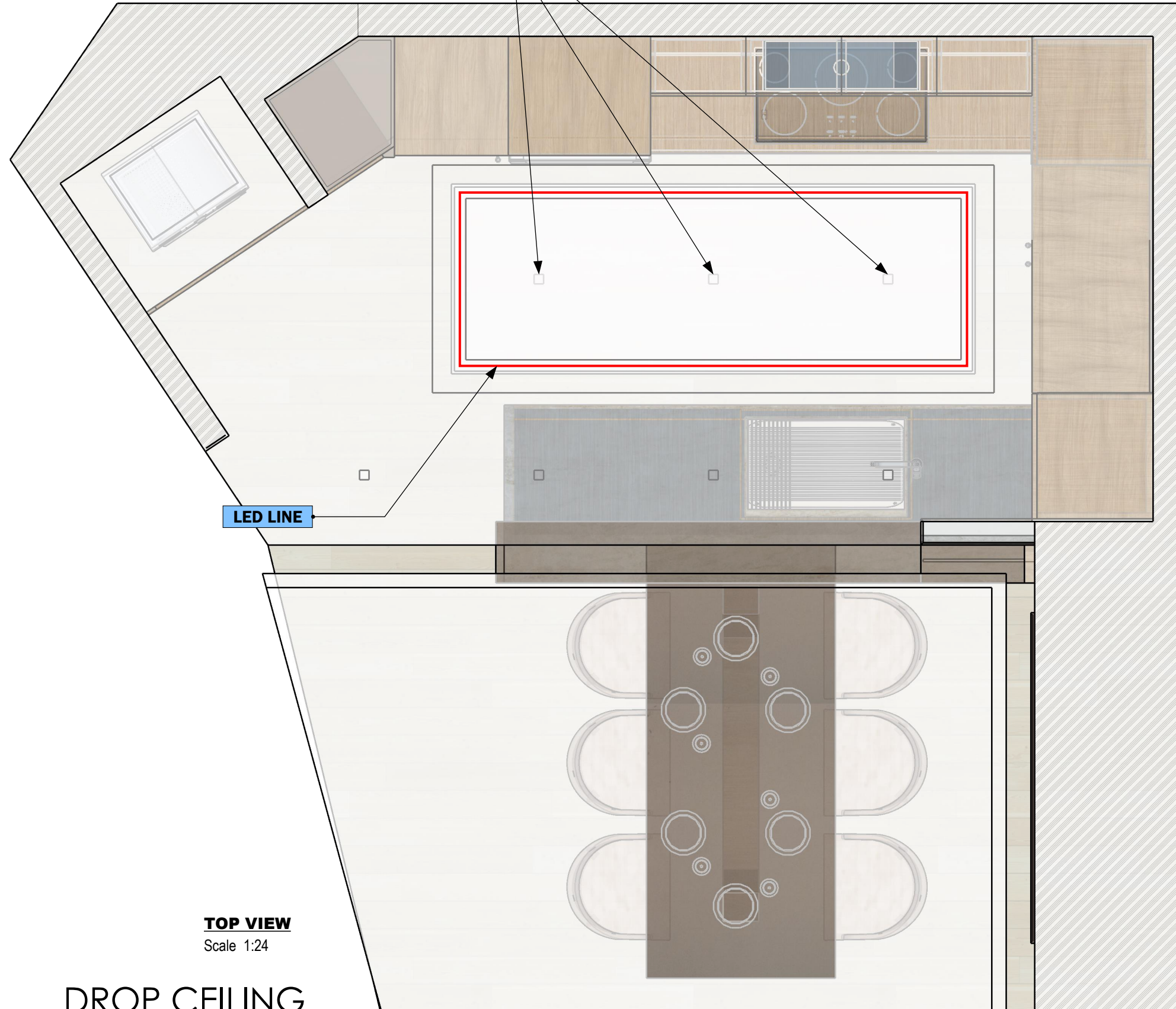

TOP VIEW
Scale 1:24

DROP CEILING

**PROGRESS DRAWING
FOR APPROVAL**



CONTACT DESIGN TEAM

BASE VERSION
SUBJECT TO REVISIONS

ISSUE
01/ 2/ 2024
RE - ISSUE
03/12/2024

3603 ICON
0000 Ft, 33000

DESIGN BY	OWNER	PAGE NAME
J. Alonso	OO	Page 5
DRAWN BY		
A. Quintero		

DESIGN CONCEPT

**ALL MEASUREMENTS
MUST BE
VERIFIED IN FIELD**

DISCARD ALL DRAWINGS THAT
WERE MADE ON THIS ITEM PRIOR
TO THE DATE BELOW:

03/12/2024

This drawing is not intended to be used
for contract pricing or fabrication
purposes.
All content is subject to change

A - 04

KITCHEN