



WESTHAVEN
CONSTRUCTION SERVICES, INC.

8254 South River Dr.
Medley, FL 33166
Ph.305 556 1416
www.westhavencn.com

**PROGRESS DRAWING
FOR APPROVAL**



CONTACT DESIGN TEAM

CLIENT
JG. **ADDRESS**
ADDRESS

PROJECT
406 **PROJECT NAME**
YUKON

DRAWN BY
Abel Q. **DESIGN BY**
Joel A. **DESCRIPTION**
AREAS

A-01

TOTAL
401.1sq. ft.

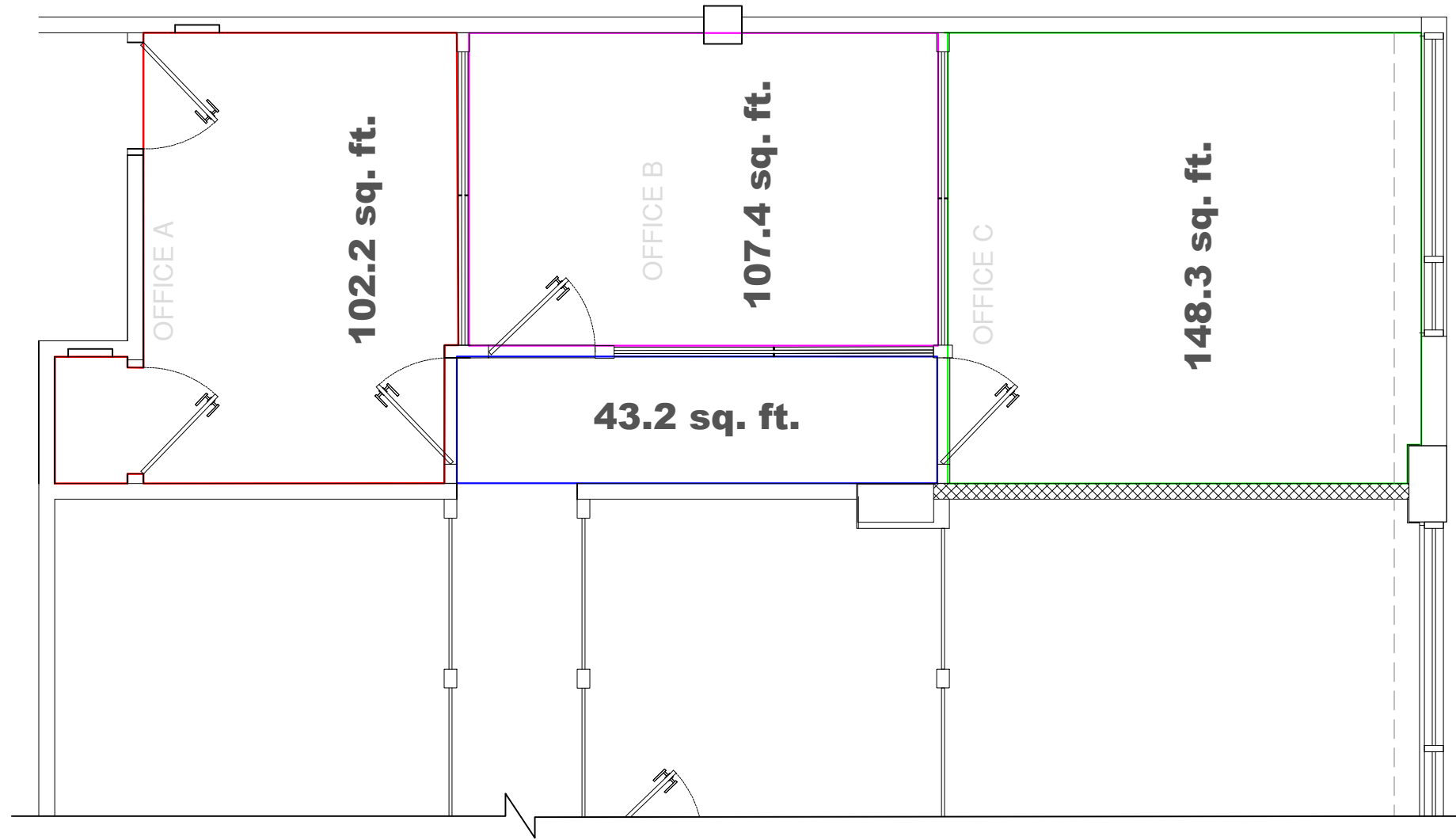

AREAS

PROGRESS DRAWING

This drawing is not intended to be used for contract pricing or fabrication purposes. All content is subject to change

DISCARD ALL DRAWINGS THAT WERE MADE ON THIS ITEM PRIOR TO THE DATE BELOW:

2023-07-31

NOTES

Drawings may not be scaled. The numerical dimensions represent correct measurements. All dimensions are given from finished floor and finished wall unless otherwise noted. All design ideas, drawings and plans represented here are owned by the property of WESTHAVEN CONSTRUCTION SERVICES. All rights reserved. Above suggested electrical and plumbing locations, must be verified in field.

Scale 1= 1/4"